

YAVAPAI COUNTY

SEDONA AIRPORT
SEDONA, ARIZONA

SOUTHWEST APRON - PHASE I

JULY 2011

FAA AIP NO. 3-04-0033-17
ADOT NO. E8F54
PROJECT #1120558

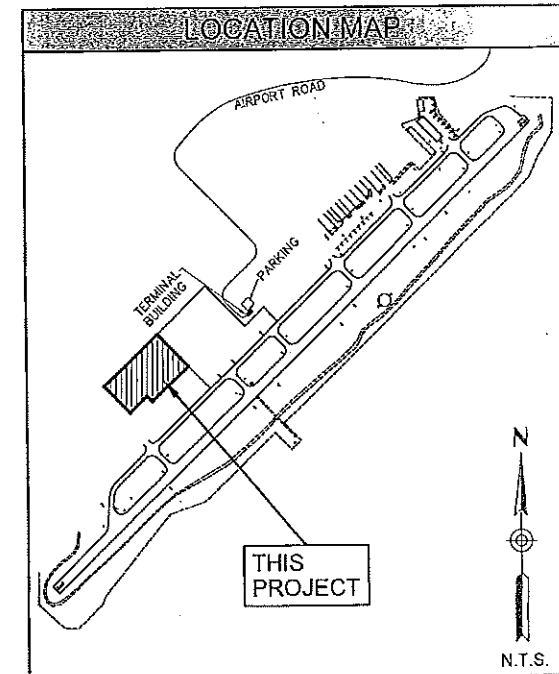
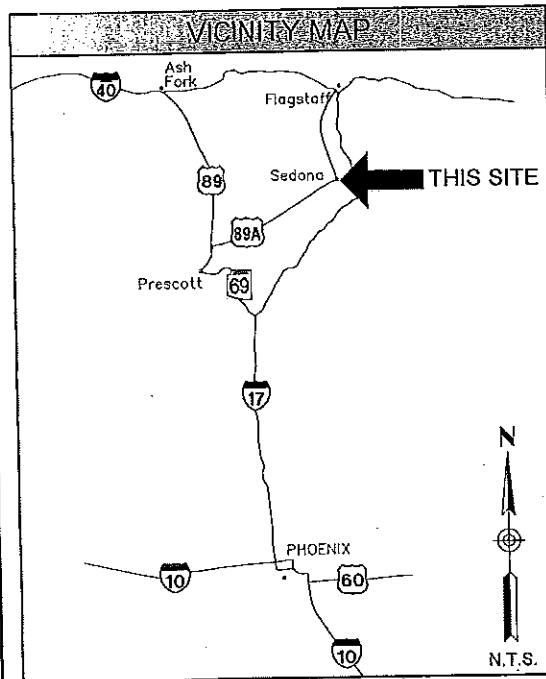

SHEET INDEX

1	COVER SHEET
2	LEGEND, QUANTITIES, & ABBREVIATIONS
3	LAYOUT & CONTROL PLAN
4	TYPICAL SECTIONS
5-6	DETAILS
7-8	STORMWATER POLLUTION PREVENTION PLAN
9	DEMOLITION PLAN
10	PAVING AND GRADING PLAN
11	MARKING AND ELECTRICAL PLAN
12-15	CROSS SECTIONS



2011-0055-1694



C & S Engineers, Inc.

9200 E Pima Center Parkway • Suite 240 • Scottsdale, Arizona 85258 • Tel (602) 997-7536 • Fax (602) 997-7592 • www.cscos.com



ABBREVIATIONS		APPROXIMATE QUANTITIES				LEGEND			
ABBREVIATION	DEFINITION	ITEM NUMBER	DESCRIPTION	QUANTITY	UNITS	AS-BUILT	DESCRIPTION	EXISTING	PROPOSED
3R/21L	RUNWAY DESIGNATION						ELEC MANHOLE/LINE/PULL BOX		
ABC	AGGREGATE BASE COURSE						POWER POLE/GUY CABLE & ANCHOR		
AC	ASPHALTIC CONCRETE	1	MOBILIZATION (SP-46)	1	LS		STREET LIGHT & W/MAST ARM		
ADOT	ARIZONA DEPARTMENT OF TRANSPORTATION	2	TRAFFIC CONTROL AND BARRICADING (SP-38)	1	LS		RUNWAY/TAXIWAY LIGHT		
AIP	AIRPORT IMPROVEMENT PROGRAM	3	STORMWATER POLLUTION AND PREVENTION (SP-31)	1	LS		FLUSH RUNWAY/TAXIWAY LIGHT		
APS	ARIZONA PUBLIC SERVICE	4	CLEARING AND GRUBBING (P-151)	5	ACRE		SANITARY SEWER & MANHOLE		
ASTM	AMERICAN SOCIETY FOR TESTING MATERIALS	5	EMBANKMENT IN PLACE (P-152)	5,500	CY		SANITARY SEWER CLEANOUT		
CL	CENTERLINE	6	SUBGRADE PREPARATION (SP-36)	20,650	SY		STORM DRAIN & MANHOLE		
C TO C	CENTER TO CENTER	7	5.5" CRUSHED AGGREGATE BASE COURSE (P-209)	21,020	SY		AIRPORT REFLECTIVE MARKER		
CMP	CORRUGATED METAL PIPE	8	SOIL STERILANT (SECTION 15)	22,270	SY		BRASS CAP FLUSH/IN HAND HOLE		
CONC	CONCRETE	9	BITUMINOUS PRIME COAT (SP-34)	20,470	SY		PROPERTY/RIGHT OF WAY LINE		
CU FT	CUBIC FEET	10	3" ASPHALTIC CONCRETE SURFACE COURSE (P-401)	20,470	SY		SECTION LINE		
CY	CUBIC YARDS	11	TENSAR BX-1200 GEOGRID (OR APPROVED EQUAL) (SP-48)	20,650	SY		CENTER/MONUMENT LINE		
CZ	CLEAR ZONE	12	NON-WOVEN GEOTEXTILE SEPARATION FABRIC (SP-47)	20,650	SY		EASEMENT		
DIA	DIAMETER	13	MISCELLANEOUS REMOVALS AND OTHER WORK (SP-45)	1	LS		VERT CURB/CURB & GUTTER		
DIP	DUCTILE IRON PIPE	14	SAWCUT AND REMOVE EXISTING AC PAVEMENT (SP-37)	2,410	SY		STREET LIGHT & W/MAST ARM		
D ₅₀	DIAMETER OF 50% ROCK SIZE	15	PAVEMENT MARKING (YELLOW REFLECTORIZED) (P-620)	1,190	SF		STREET SIGN		
E	EAST	16	PAVEMENT MARKING (WHITE NON-REFLECTORIZED) (P-620)	150	SF		SINGLE & DOUBLE POST SIGNS		
EA	EACH	17	6" CHAIN LINK FENCE WITH 3-STRAND BARBED WIRE (F-162)	60	LF		BOLLARD		
ELEC	ELECTRIC/ELECTICAL	18	4" AGGREGATE BASE COURSE (SP-49)	2,660	SY		CHAIN LINK FENCE		
ELEV	ELEVATION	19	18" CMP (D-701)	65	LF		CONTOUR LINES		
EXST	EXISTING	20	L-853 ELEVATED EDGE REFLECTORS (SP-50)	29	EA		GRADE BREAK		
FAA	FEDERAL AVIATION ADMINISTRATION	21	TIE-DOWN ANCHORS AND ASSEMBLIES (SP-35)	24	EA		BUILDING/STRUCTURE		
FIN	FINISHED	22	DROP INLET HEADWALL (MAG STD DTL 501-5) (SP-57)	1	EA		AC PAVEMENT		
FL	FLOW LINE	23	OUTLET HEADWALL (YAG STD DTL 501-1, "U" TYPE) (SP-52)	1	EA		CONCRETE PAVEMENT		
FT	FOOT	24	2-2" PVC CONCRETE ENCASED DUCT BANK (L-110)	330	LF		EROSION CONTROL		
GPM	GALLONS PER MINUTE	25	2-2" PVC DUCT BANK (L-110)	100	LF		CONSTRUCTION NOTE		
ID	INSIDE DIAMETER	26	APRON LIGHTING SYSTEM (SP-53)	1	LS		CURVE DATA		
IE	INVERT ELEVATION	27	TURF REINFORCING MAT (SP-54)	1,130	SY				
JB	JUNCTION BOX								
L	LENGTH								
LBS	POUNDS								
LF	LINEAL FOOT								
LS	LUMP SUM								
LT	LEFT								
MAG	MARICOPA ASSOCIATION OF GOVERNMENTS								
MAX	MAXIMUM								
MH	MANHOLE								
MIN	MINIMUM								
N	NORTH								
NO.	NUMBER								
NPI	NON-PAY ITEM								
NTS	NOT TO SCALE								
N/A	NOT APPLICABLE								
OC	ON CENTER								
OD	OUTSIDE DIAMETER								
PROP	PROPOSED								
PVC	POLYVINYL CHLORIDE								
PVMT	PAVEMENT								
R	RADIUS								
RCP	REINFORCED CONCRETE PIPE								
REINF	REINFORCING								
ROW	RIGHT-OF-WAY								
RSA	RUNWAY SAFETY AREA								
RT	RIGHT								
RW	RUNWAY								
S	SOUTH								
SAL	SAFETY AREA LIMITS								
SD	STANDARD DETAIL								
SECT	SECTION								
SHT	SHEET								
SPECS	SPECIFICATIONS								
STA	STATION								
SY	SQUARE YARDS								
S=	SLOPE								
T	TANGENT LENGTH								
TSA	TAXIWAY SAFETY AREA								
TW	TAXIWAY								
TYP	TYPICAL								
UG	UNDERGROUND								
VCP	VITRIFIED CLAY PIPE								
W	WEST								
w	WATT								
WT	WEIGHT								
YAG	YAVAPAI ASSOCIATION OF GOVERNMENTS								
#	REBAR SIZE NUMBER								
@	AT								

SEDONA AIRPORT
SEDONA, ARIZONA

SOUTHWEST APRON - PHASE I

LEGEND, QUANTITIES,
& ABBREVIATIONS

C&S Companies
5200 E. Plaza Center Parkway, Ste 240
Scottsdale, Arizona 85255
Phone: (480) 997-7535
Fax: (480) 997-7532
www.cscos.com

Exp: 9-30-11

LAYOUT NOTES

PROJECT NO:	DESIGNED BY:	DRAWN BY:	CHECKED BY:	DATE:	SCALE:	SHEET:
07045	MG	MG	LM	7-2011	NONE	2 OF 15

07/27/11 10:00 AM - JUL 27, 2011
 L:\PROJECTS\SEDONA\PHASE I - DEVELOPMENT OF NOTE - PHASE I.dwg
 mgmalien

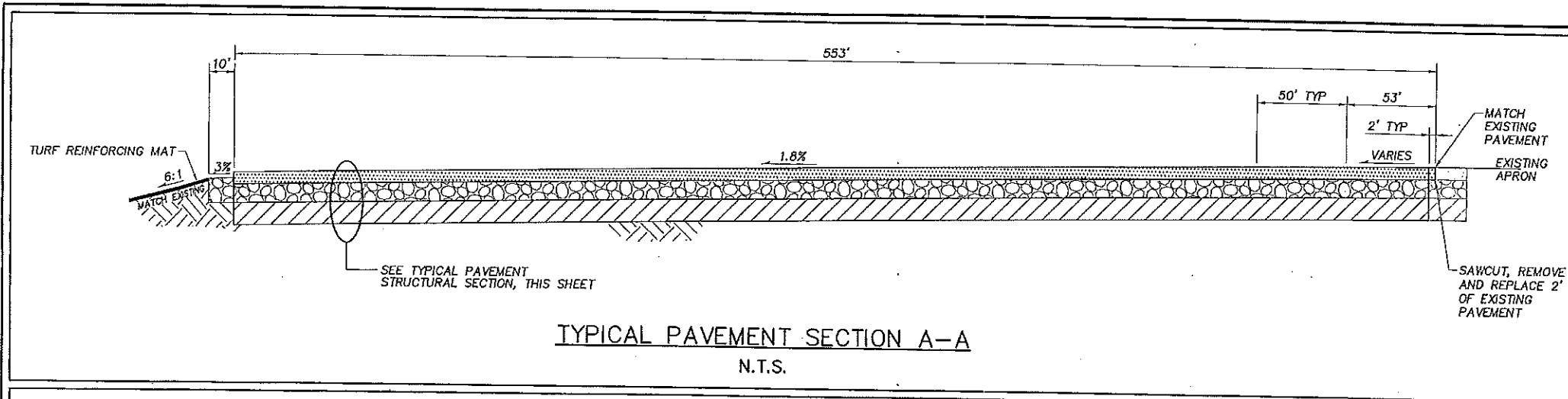

TYPICAL PAVEMENT SECTION A-A
N.T.S.

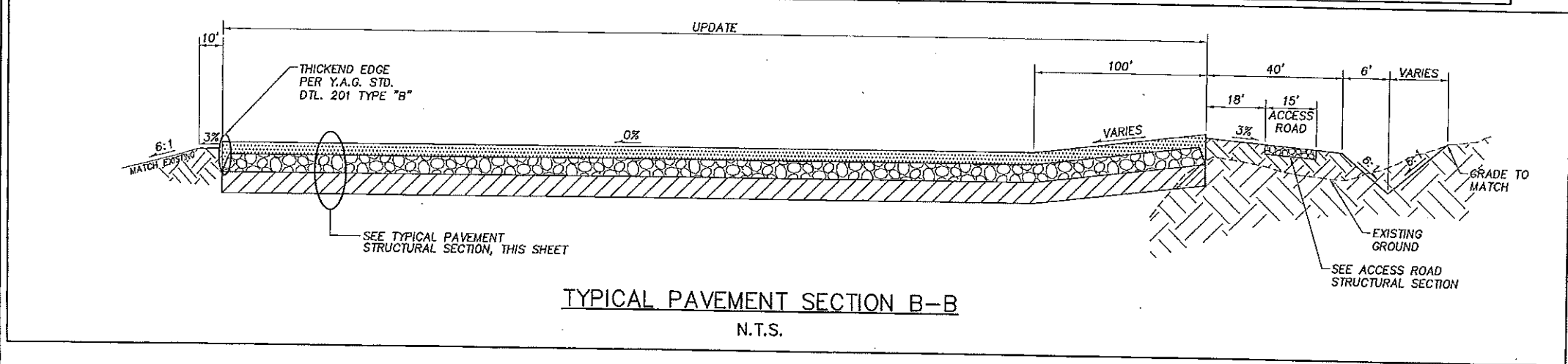

TYPICAL PAVEMENT SECTION B-B
N.T.S.

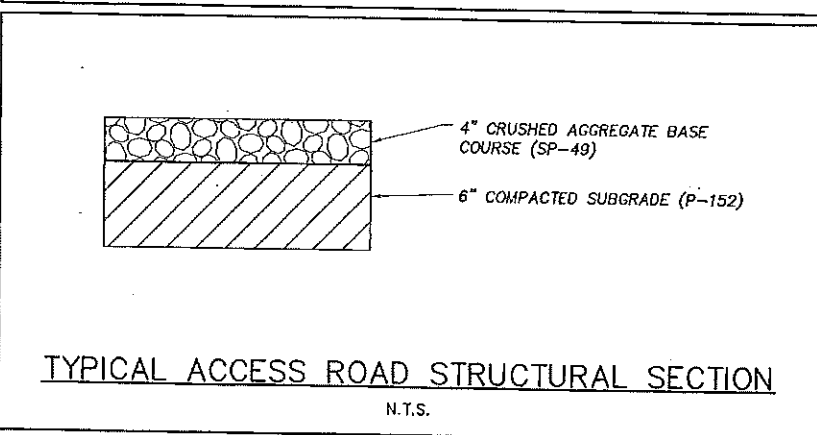
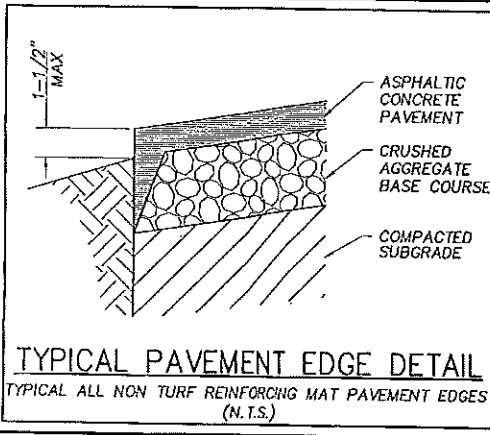
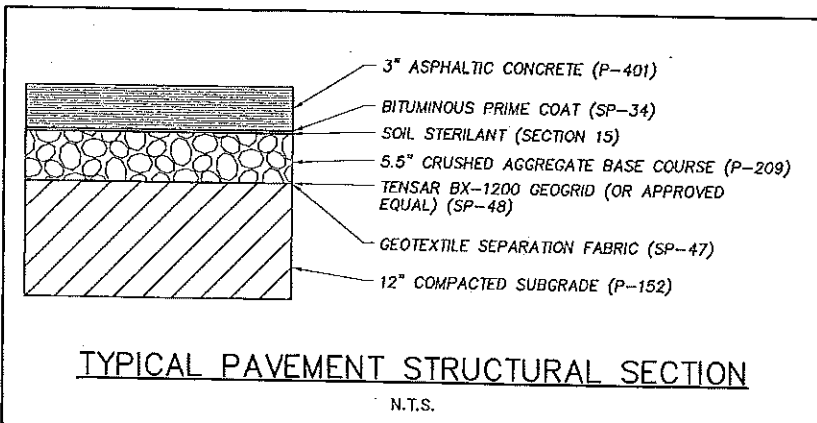
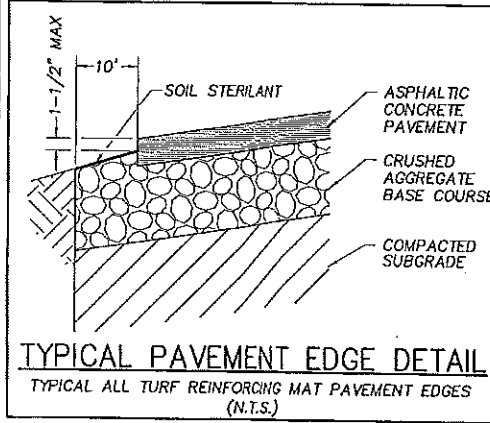

SEDONA AIRPORT
SEDONA, ARIZONA

SOUTHWEST APRON - PHASE I

TYPICAL SECTIONS

C&S COMPANIES
C&S Engineers, Inc.
9200 E. Pima Center Parkway, Ste 240
Scottsdale, Arizona 85253
Phone: (602) 597-7536
Fax: (602) 597-7592
www.ccs.com

DESIGNED BY: MO
EXAM BY: GMD
CHECKED BY: LM
DATE: 7-2011

SCALE: 9 FEET
AS SHOWN 4 OF 15

PROJECT NO.: 07045

DATE: 9-30-11

02/26/14 PM - Jul 02/2011
 U:\PROJECTS\SEDONA\07045\PAVE 1 - DMC\07045 ON TYP - PAVES.dwg
 02/26/14 PM - Jul 02/2011
 U:\PROJECTS\SEDONA\07045\PAVE 1 - DMC\07045 ON TYP - PAVES.dwg

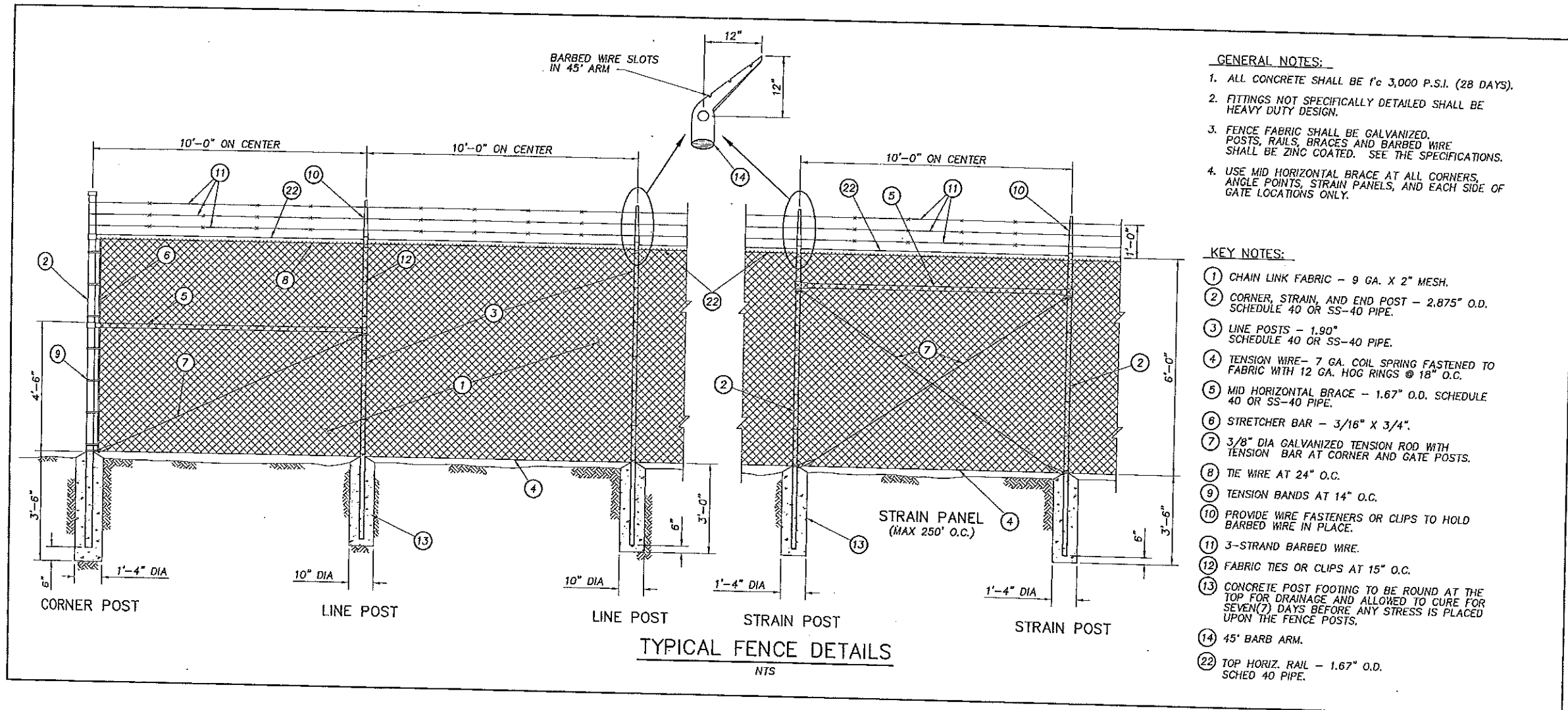

- GENERAL NOTES:**
1. ALL CONCRETE SHALL BE f'c 3,000 P.S.I. (28 DAYS).
 2. FITTINGS NOT SPECIFICALLY DETAILED SHALL BE HEAVY DUTY DESIGN.
 3. FENCE FABRIC SHALL BE GALVANIZED. POSTS, RAILS, BRACES AND BARBED WIRE SHALL BE ZINC COATED. SEE THE SPECIFICATIONS.
 4. USE MID HORIZONTAL BRACE AT ALL CORNERS, ANGLE POINTS, STRAIN PANELS, AND EACH SIDE OF GATE LOCATIONS ONLY.

- KEY NOTES:**
- 1 CHAIN LINK FABRIC - 9 GA. X 2" MESH.
 - 2 CORNER, STRAIN, AND END POST - 2.875" O.D. SCHEDULE 40 OR SS-40 PIPE.
 - 3 LINE POSTS - 1.90" SCHEDULE 40 OR SS-40 PIPE.
 - 4 TENSION WIRE - 7 GA. COIL SPRING FASTENED TO FABRIC WITH 12 GA. HOG RINGS @ 18" O.C.
 - 5 MID HORIZONTAL BRACE - 1.67" O.D. SCHEDULE 40 OR SS-40 PIPE.
 - 6 STRETCHER BAR - 3/16" X 3/4".
 - 7 3/8" DIA GALVANIZED TENSION ROD WITH TENSION BAR AT CORNER AND GATE POSTS.
 - 8 TIE WIRE AT 24" O.C.
 - 9 TENSION BANDS AT 14" O.C.
 - 10 PROVIDE WIRE FASTENERS OR CLIPS TO HOLD BARBED WIRE IN PLACE.
 - 11 3-STRAND BARBED WIRE.
 - 12 FABRIC TIES OR CLIPS AT 15" O.C.
 - 13 CONCRETE POST FOOTING TO BE ROUND AT THE TOP FOR DRAINAGE AND ALLOWED TO CURE FOR SEVEN(7) DAYS BEFORE ANY STRESS IS PLACED UPON THE FENCE POSTS.
 - 14 45° BARB ARM.
 - 22 TOP HORIZ. RAIL - 1.67" O.D. SCHED 40 PIPE.

TYPICAL FENCE DETAILS
NTS

09/14/10 AM - Jul 02, 2011 1:15 PM - PROJECT: SEDONA AIRPORT PHASE I - SWAP - PHASE I

SEDONA AIRPORT SEDONA, ARIZONA	
SOUTHWEST APRON - PHASE I	
DETAILS	
 C&S COMPANIES	C&S Engineers, Inc. 9200 E. Pima Center Parkway, Ste 240 Scottsdale, Arizona 85258 Phone: (602) 997-7535 Fax: (602) 997-7592 www.cscs.com
	 JESSICA L. WALLEN PROFESSIONAL ENGINEER No. 12345 State of Arizona
LAYOUT: DTL 1 PROJECT NO: 07045 DESIGNED BY: MG DRAWN BY: GMS CHECKED BY: LM DATE: 7-2011	Exp: 8-20-11 SCALE: NTS SHEET: 5 OF 15

NO WORK IS TO BE DONE
CALL FOR PERMITS
1-800-574-4111
1-800-782-5348

NOTE:
NUMERICAL DESIGNATION VARIES
FOR EACH TIE-DOWN SPACE.

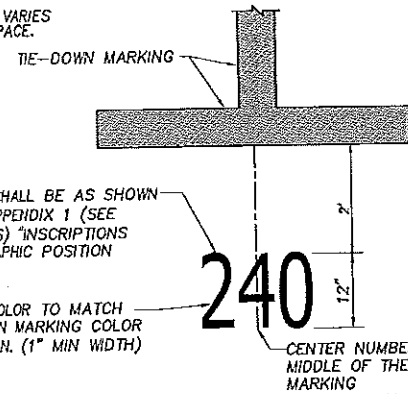

TIE-DOWN SPACE NUMBER DETAIL
NTS

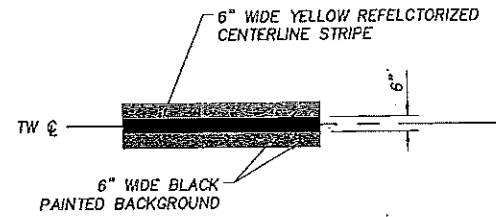

TAXIWAY CENTERLINE
MARKING DETAIL
NTS

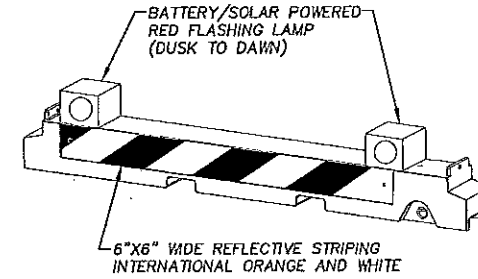

LOW PROFILE SAFETY BARRICADE
NTS

BARRICADE NOTES:

1. MAXIMUM SPACING BETWEEN BARRICADES SHALL BE 10 FEET. BARRICADES SHALL BE SET BACK 2 FEET FROM THE LIMITS OF CONSTRUCTION.
2. THE CONTRACTOR SHALL BE RESPONSIBLE FOR MAINTAINING PROPER POSITIONING OF ALL BARRICADES.
3. WATER-FILLED TYPE BARRICADES SHALL BE USED (SEE SPECIFICATIONS)
4. BARRICADES SHALL HAVE TWO FLASHING LAMPS.

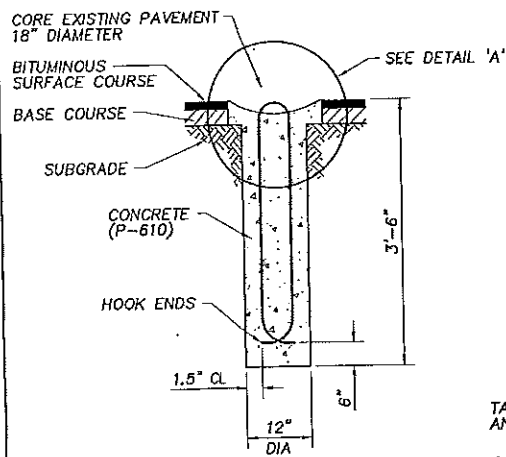

TIE-DOWN CHAIN ATTACHMENT DETAIL

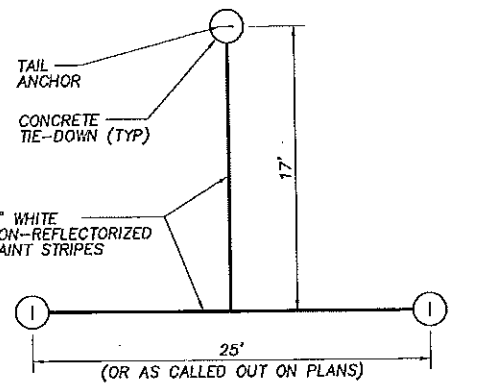

TIE-DOWN ACCESSORIES REQUIRED

THE CONTRACTOR SHALL PROVIDE THE BELOW MENTIONED ITEMS (OR APPROVED EQUALS) FOR EACH TIE-DOWN ANCHOR LOCATION:

- VENDOR: MARTINSON ENTERPRISE
 BRAND: CHAINMASTER
 1-#72 S HOOK 130 POUND LOAD
 3-#2/0 STRAIGHT LINK CHAIN 520 POUND STRENGTH (ONE 8' LENGTH FOR TAILS & TWO 12' LENGTH FOR WINGS)
- BRAND: CROSBY
 1-1/2" SCREW PIN ANCHOR SHACKLE 2 TON LOAD
 1-1/4" SCREW PIN ANCHOR SHACKLE 1/2 TON LOAD

NOTES:

EACH TIE-DOWN TO INCLUDE TRADE SIZE 2/0 HOT GALVANIZED COIL CHAIN (STRAIGHT LINK) AS MANUFACTURED BY CAMPBELL, OR EQUAL. A LENGTH OF 8' SHALL BE CONNECTED TO EACH TAIL ANCHOR AND A LENGTH OF 12' TO BE ATTACHED TO EACH WING ANCHOR. ANCHORS SHALL BE INSTALLED AFTER PAVING IS COMPLETE. TIE-DOWN CHAINS SHALL BE ATTACHED TO TIE-DOWN ANCHORS PER TIE-DOWN ATTACHMENT DETAIL. TIE DOWN CHAINS SHOULD NOT BE INSTALLED BEFORE CONCRETE HAS REACHED REQUIRED STRENGTH.

CONCRETE TIE-DOWN DETAIL
NTS

DETAIL 'A'
NTS

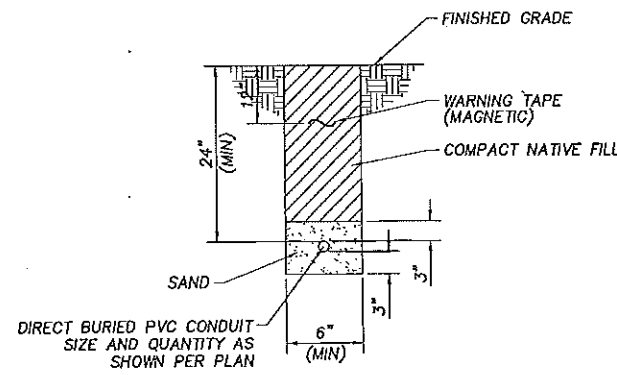

DIRECT BURIED DUCT DETAIL
NTS

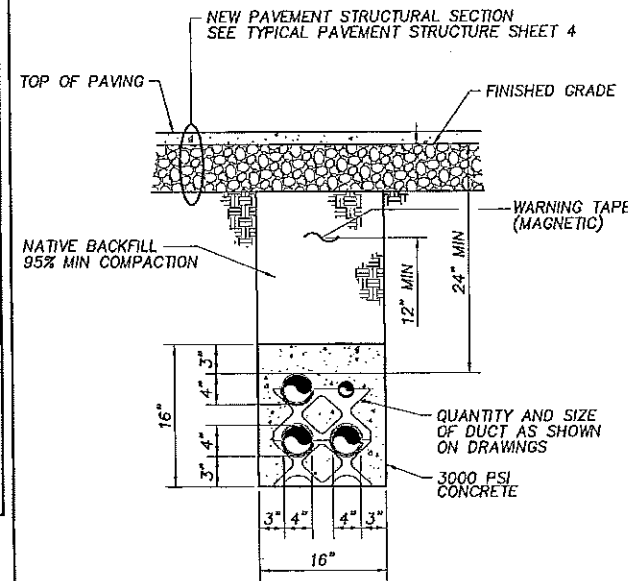

CONCRETE ENCASED DUCT DETAIL
NTS

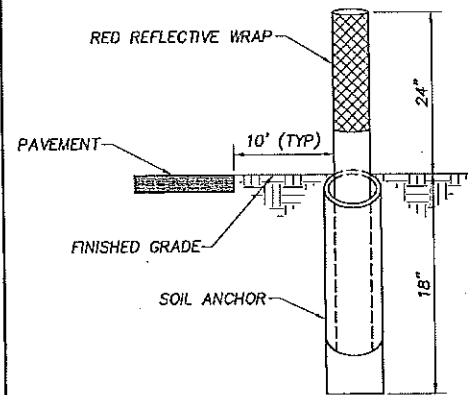

RETRO-REFLECTIVE
MARKER (L-853)
NTS

SEDONA AIRPORT SEDONA, ARIZONA	
SOUTHWEST APRON - PHASE I	
DETAILS	
	C&S Engineers, Inc. 5200 E. Plaza Center Parkway, Ste 249 Scottsdale, Arizona 85258 Phone: (602) 597-1515 Fax: (602) 597-1592 www.ccsai.com
LAYOUT: DTL 2	DATE: 9-30-11
PROJECT NO.: 07045	DESIGNED BY: MG
DRAWN BY: GMG	CHECKED BY: LM
SCALE: NTS	SHEET: 6 OF 15

10/14/13 AM 10:45:20 AM
 L:\PROJECTS\SEDONA\PHASE I - DIRECT BURIED DUCT - PHASE I.dwg
 11/15/11

02/04/11 AM - Jul 02, 2011 murrell L:\PROJECTS\SEDONA\STORMWATER\1 - SWAPR\1 - SWAPR\1 - SWAPR - PHASE I.dwg

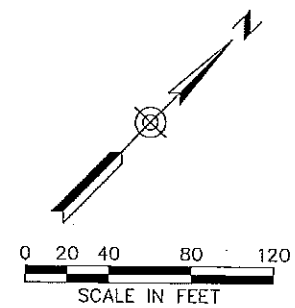
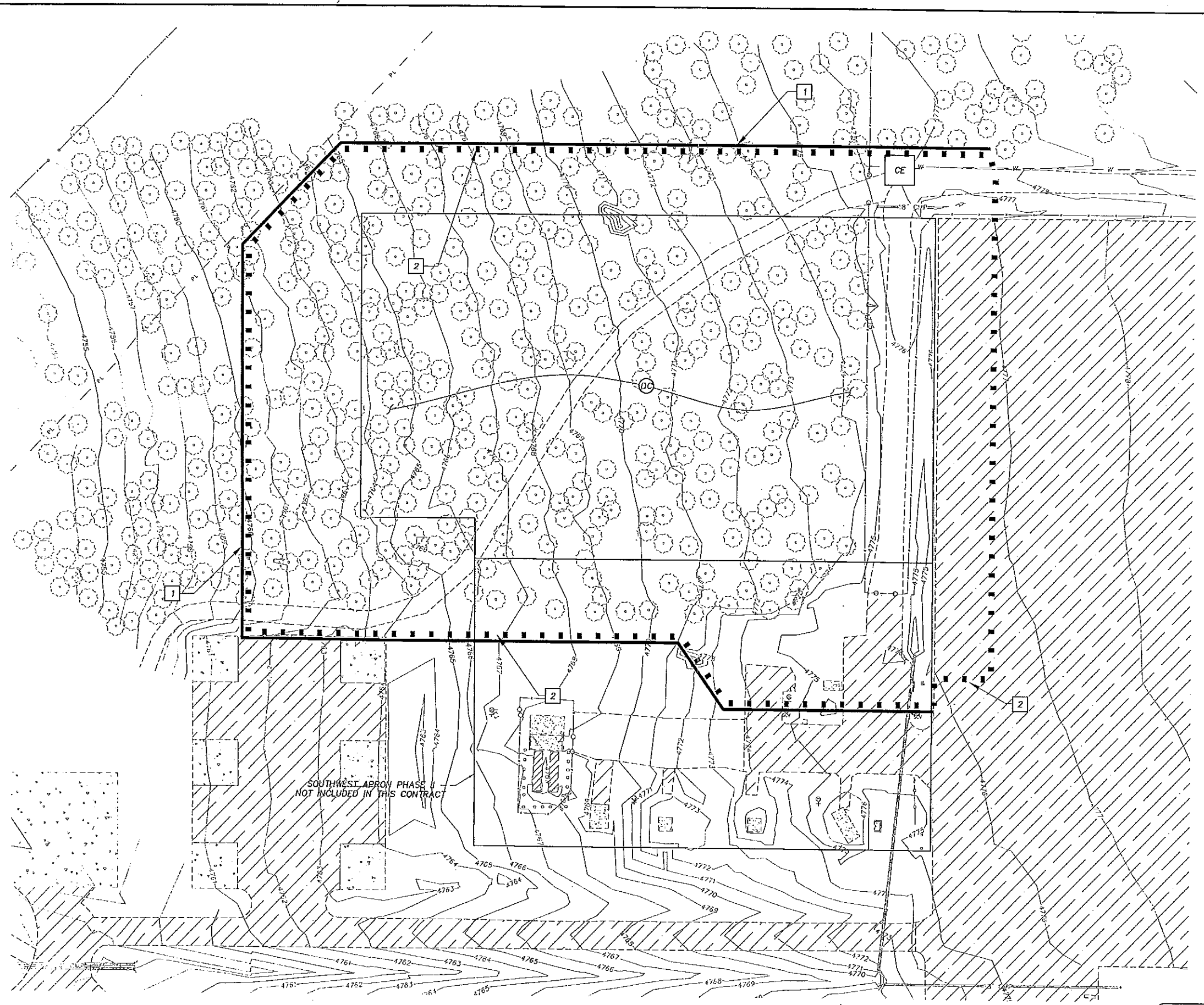

LEGEND		
NUMBER	DESCRIPTION	SYMBOL
1	PROPOSED SILT FENCE	—
2	LIMIT OF GRADING	&
CE	CONSTRUCTION ENTRANCE	CE
DC	DUST CONTROL	DC

SEDONA AIRPORT
 SEDONA, ARIZONA
 SOUTHWEST APRON - PHASE I

STORMWATER POLLUTION PREVENTION PLAN

C&S Companies, Inc.
 9200 E. Pima Center Parkway, Ste 240
 Scottsdale, Arizona 85258
 Phone: (602) 997-7336
 Fax: (602) 997-7392
 www.candcs.com

1-800-333-3344
 1-800-STAKE-IT
 1-800-782-8348

LAYOUT: SWPP - 1	PROJECT NO.: 07045	DESIGNED BY: MG	DRAWN BY: GVG	CHECKED BY: LM	DATE: 7-2011	SCALE: NONE	SHEET: 7 OF 15
------------------	--------------------	-----------------	---------------	----------------	--------------	-------------	----------------

EROSION & SEDIMENT CONTROL NOTES

1. An approved copy of the grading and drainage plan, a copy of the Notice of Intent (NOI), and the Stormwater Pollution Prevention Plan (SWPPP) shall be maintained on the project site and be available for review. Those elements of the grading and drainage plan pertinent to or referenced in the SWPPP shall be considered a part of the SWPPP.
2. The contractor shall place at all project entrance/exit locations 6" minimum ABC, 30'x50' long to aid in the prevention of tracking soil from the site. The ABC shall occasionally be regraded to remove any accumulated soil.
3. The contractor shall perform at a minimum a visual inspection of the project site once every month and after each rainfall event resulting in 0.5 inches or more of rainfall in a 24 hour period. The inspector shall prepare a report documenting the findings on the conditions of the SWPPP controls and note any erosion or sediment transport problem areas.
4. The contractor shall amend this plan as necessary during construction to correct any problem areas which become evident during construction and/or as a result of rainfall.
5. The contractor shall file a Notice of Termination (NOT) after completion of construction which includes the final landscaping.
6. The contractor shall retain all records associated with the SWPPP including the NOI, SWPPP, NOT and inspection reports on file for a minimum of 3 years from the date of filing the NOT.
7. All erosion and sediment control works shall conform to the standard specifications of the Drainage Design Manual for Maricopa County, Arizona (Volume III, Erosion Control), and construction project special provisions. In the event of conflict, the decision of the City's Engineer Representative will prevail.

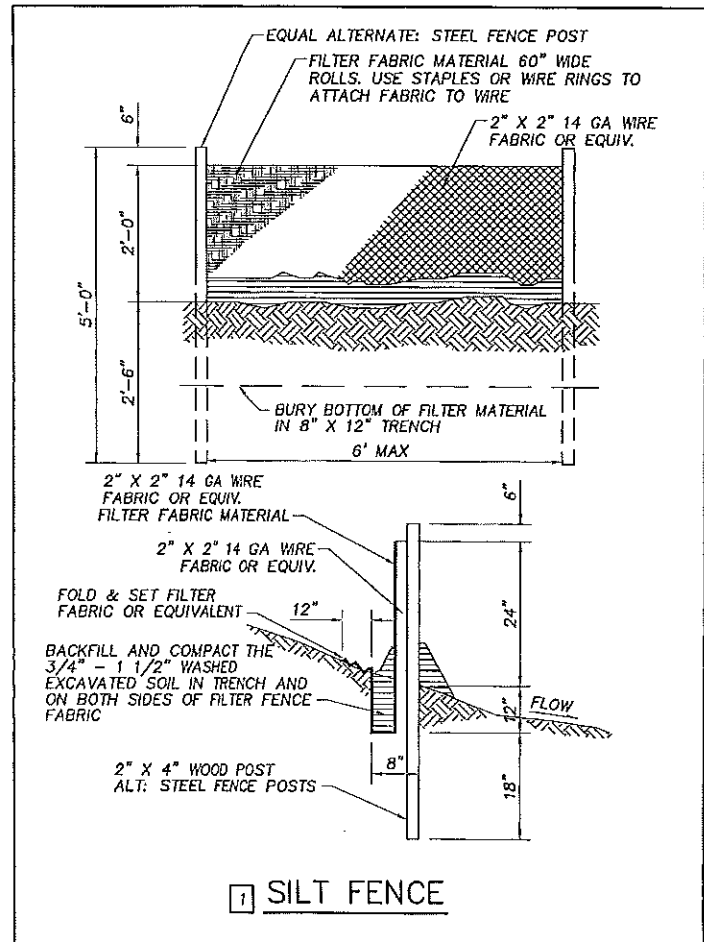
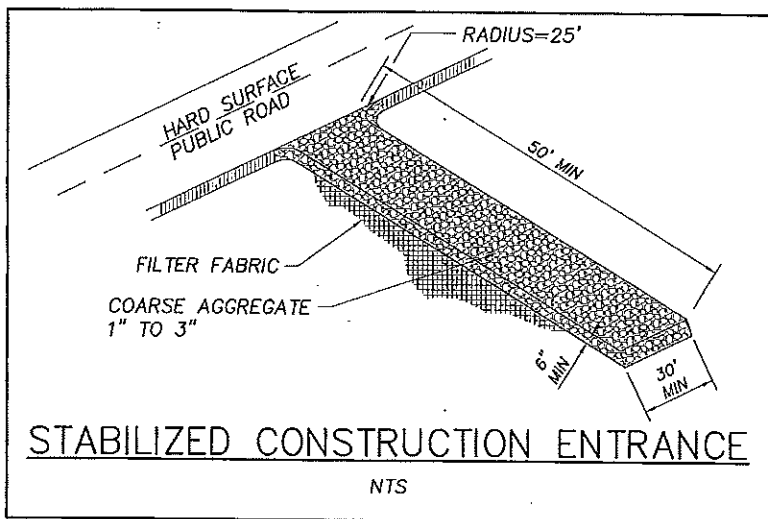

SEDONA AIRPORT SEDONA, ARIZONA	
SOUTHWEST APRON - PHASE I	
STORMWATER POLLUTION PREVENTION PLAN	
 C&S COMPANIES	C&S Engineers, Inc. 9200 E. Pima Center Parkway, Ste 240 Scottsdale, Arizona 85258 Phone: (602) 997-7336 Fax: (602) 997-7392 www.cscs.com
	Engineer: 9-32-11
LAYOUT: SWPP - 2 PROJECT NO.: 07045 DESIGNED BY: MG DRAWN BY: RJB CHECKED BY: LM DATE: 7-2011 SCALE: NONE SHEET: 8 OF 15	

09/25/2011 AM 7:02:20 PM \\PROJECT\EDWARDS\DWG\SWPP - FENCE.dwg

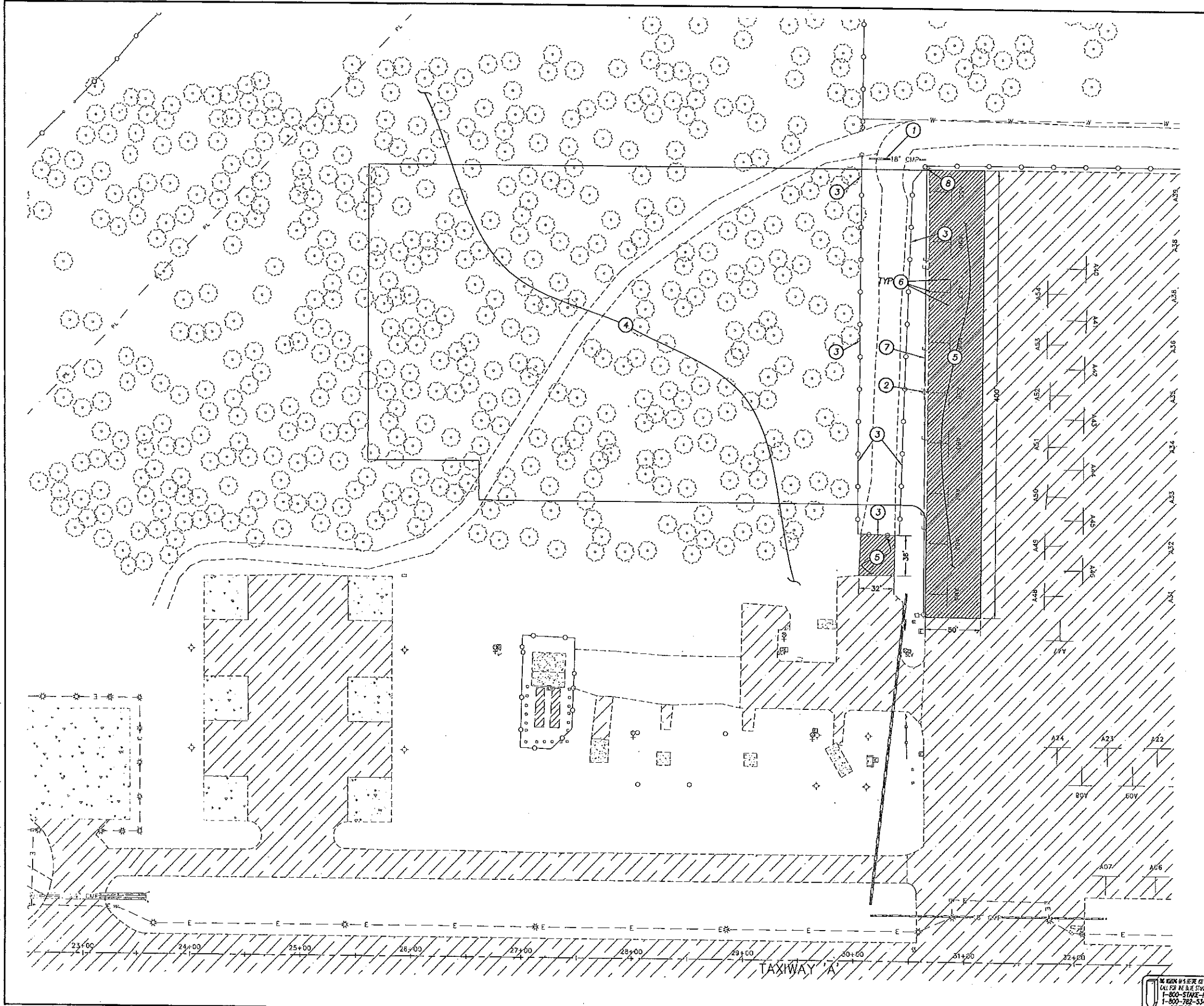

DEMOLITION NOTES

- ① REMOVE 18" CMP.
- ② REMOVE AND SALVAGE EXISTING LIGHT POLE.
- ③ REMOVE AND SALVAGE EXISTING FENCE AND GATES.
- ④ REMOVE EXISTING TREES WITHIN PROJECT GRADING LIMITS SHOWN ON SHEET 7.
- ⑤ REMOVE AND DISPOSE OF EXISTING ASPHALT PAVEMENT STRUCTURAL SECTION.
- ⑥ REMOVE AND DISPOSE OF EXISTING TIE-DOWN ANCHORS. SALVAGE EXISTING TIE-DOWN CHAINS AND TURN OVER TO AIRPORT.
- ⑦ REMOVE EXISTING APRON LIGHTING CIRCUIT AND CONDUIT.
- ⑧ REMOVE EXISTING LIGHT POLE AND INSTALL LIGHT FIXTURE AND MAST ARM PERPENDICULAR TO PAVEMENT EDGE.

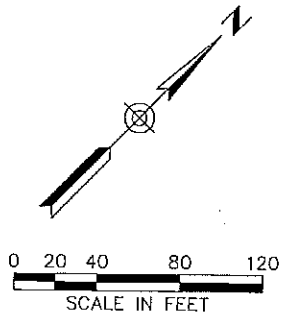

SEDONA AIRPORT
SEDONA, ARIZONA

SOUTHWEST APRON - PHASE I

DEMOLITION PLAN

C&S COMPANIES
C&S Engineers, Inc.
9200 E. Pima Center Parkway, Ste 242
Scottsdale, Arizona 85258
Phone: (602) 997-7535
Fax: (602) 997-7592
www.ccs.com



LAYOUT: DEMO							
PROJECT NO:	DESIGNED BY:	DRAWN BY:	CHECKED BY:	DATE:	SCALE:	SHEET:	
07045	MG	GMG	LM	7-2011	1"=40'	9	OF 15

07/25/08 AM - Jul 02/2011 1:00 PM - C:\PROJECTS\SEDONA\07045\PHASE I - DEMO\07045.DWG - PMS:lmj



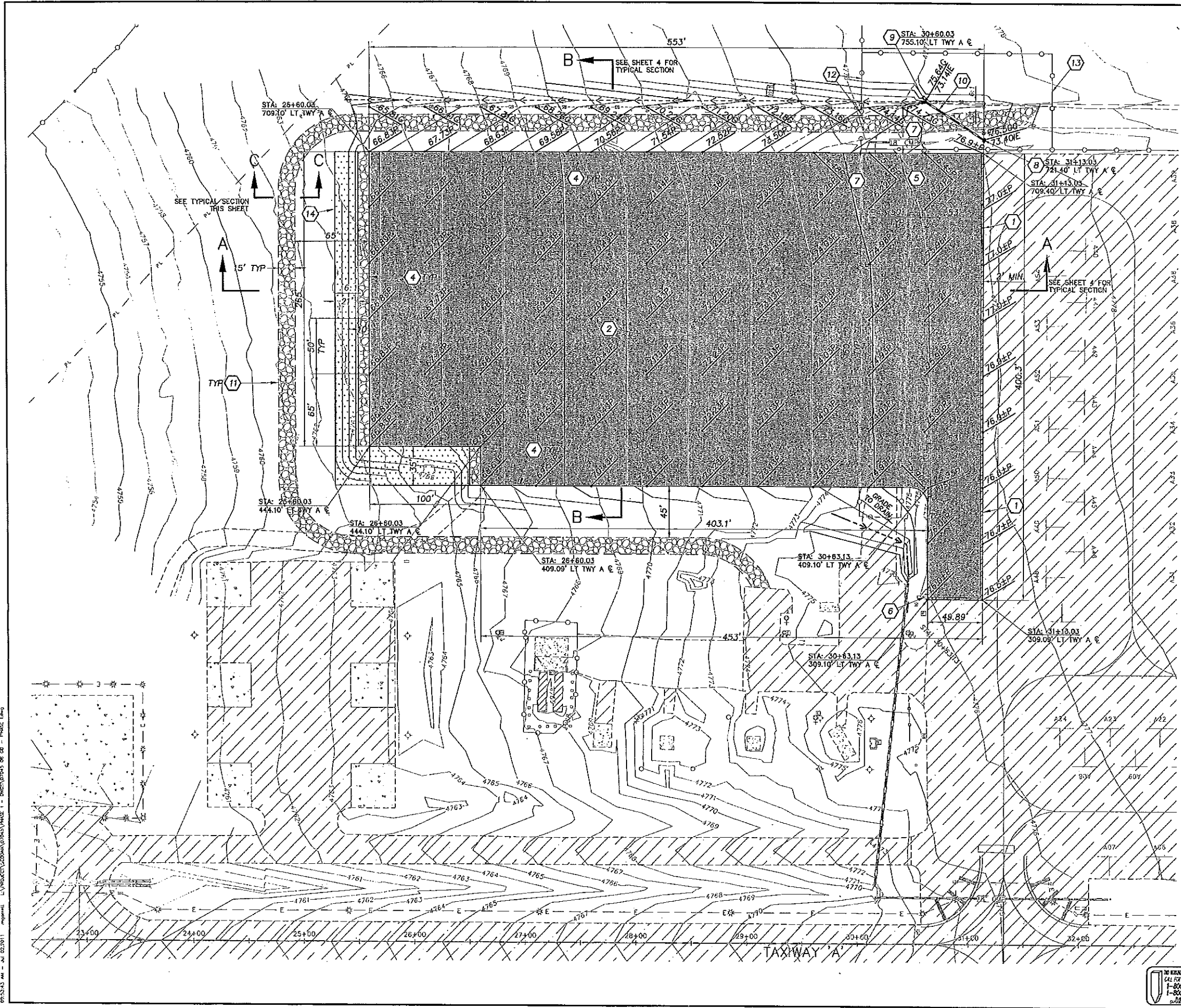

CONSTRUCTION NOTES

- ① SAWCUT AND REMOVE EXISTING PAVEMENT, 2' MIN.
- ② CONSTRUCT NEW AC PAVEMENT PER TYPICAL PAVEMENT STRUCTURAL SECTION, SHEET 4.
- ④ CONSTRUCT THICKENED EDGE PER Y.A.G. STD. DET. 201, TYPE "B".
- ⑤ FURNISH & INSTALL CHAIN LINK FENCE TO MATCH EXISTING. SEE DETAIL SHEET 5.
- ⑥ PROTECT EXISTING LIGHTS IN PLACE.
- ⑦ CONNECT NEW FENCE TO EXISTING FENCING.
- ⑧ CONSTRUCT DROP INLET HEADWALL PER MAG STD DTL 501-5.
- ⑨ CONSTRUCT OUTLET HEADWALL PER YAG STD DTL 501-1, 'U' TYPE.
- ⑩ FURNISH & INSTALL 18" CMP.
- ⑪ CONSTRUCT ACCESS ROAD. SEE TYPICAL ACCESS ROAD STRUCTURAL SECTION, SHEET 4.
- ⑫ REMOVE, SALVAGE AND REPLACE EXISTING CHAIN LINK FENCING AND GATE.
- ⑬ CONTRACTOR TO INSTALL TEMPORARY FENCE AND GATES TO MATCH EXISTING.
- ⑭ PLACE TURF REINFORCING MAT PER SPECIFICATIONS.

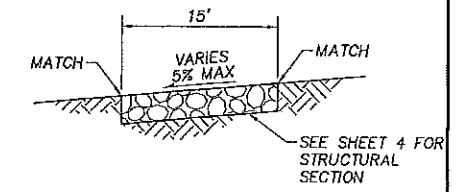

TYPICAL ACCESS ROAD SECTION C-C
NTS

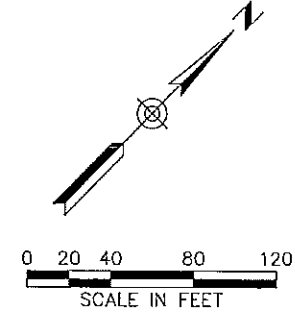

SEDONA AIRPORT
SEDONA, ARIZONA
SOUTHWEST APRON - PHASE I

PAVING & GRADING PLAN

C&S Companies
C&S Engineers, Inc.
5200 B. Plaza Center Parkway, Ste 240
Scottsdale, Arizona 85253
Phone: (602) 977-7535
Fax: (602) 977-7592
www.cscs.com



PROJECT NO:	DESIGNED BY:	DRWN BY:	CHECKED BY:	DATE:	SCALE:	SHEET:
07045	MG	MG	LM	7-2011	1"=40'	10 OF 15

07/23/11 08:43 AM - JUL 22 2011 10:00 AM
 L:\PROJECTS\SEDONA\PHASE I - DIRECTOR'S DR GR - PHASE I.dwg
 1-800-STAKE-IT
 1-800-742-5348
 C&S Companies

CONSTRUCTION NOTES

- (20) PAINT 6" WIDE YELLOW REFLECTORIZED TAXILANE CENTERLINE MARKING. SEE DETAIL SHEET 6.
- (23) MATCH EXISTING STRIPING.
- (24) FURNISH & INSTALL 24" ELEVATED EDGE REFLECTOR, FAA L-853, WITH RED REFLECTIVE SHEETING AND WHITE BASE. POSTS SHALL BE SOIL MOUNTED.
- (26) PAINT 4" WIDE WHITE NON-REFLECTORIZED TIE-DOWN MARKING PER DETAIL SHEET 6.
- (27) FURNISH AND INSTALL TIE-DOWN ANCHORS PER CONCRETE TIE DOWN DETAIL, SHEET 6.
- (28) PAINT TIEDOWN MARKING NUMBER PER DETAIL SHEET 6.
- (29) FURNISH & INSTALL 2-2" PVC CONCRETE ENCASED DUCT BANK PER DETAIL SHEET 6.
- (30) FURNISH & INSTALL 2-2" PVC DUCT BANK PER DETAIL SHEET 6.
- (31) FURNISH & INSTALL LIGHTING CIRCUIT CONDUCTORS TO MATCH EXISTING. CONNECT LIGHTING CIRCUIT TO EXISTING APRON LIGHTING FIXTURES.

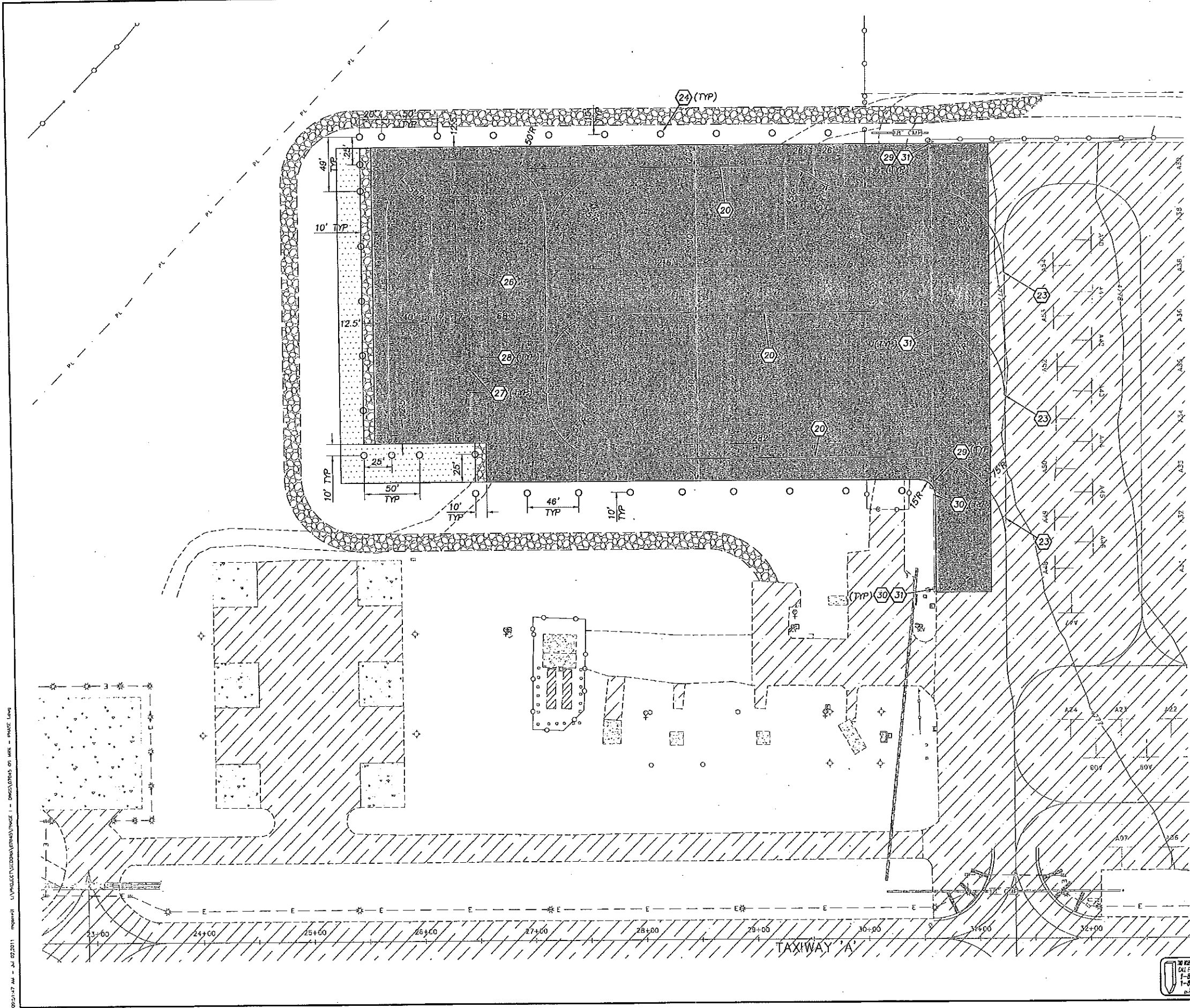

09/21/11 11:45 AM - JUL 27 2011 - PROJECT: SEDONA AIRPORT - PHASE I - MARKING AND ELECTRICAL PLAN

08:52:00 AM - JUL 02 2011 10:00 AM - L:\PROJECTS\SEDONA\PHASE I - SW APRON\10 X SECTIONS - PHASE I.dwg

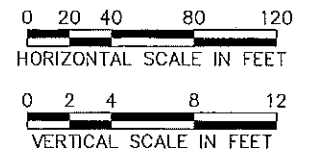
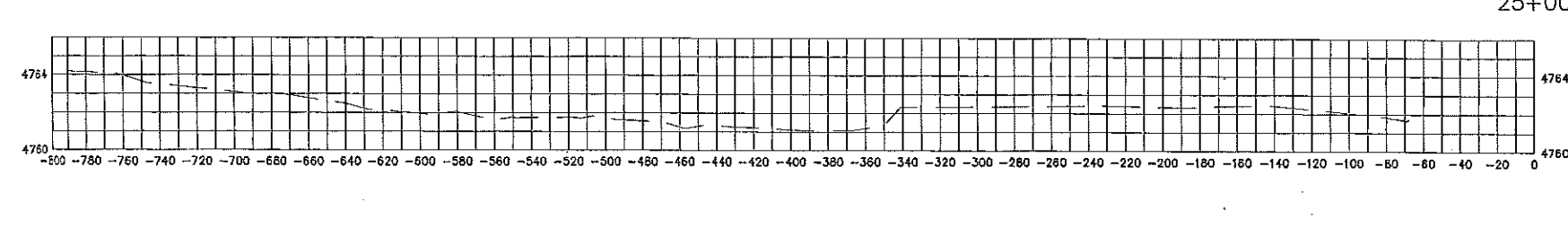
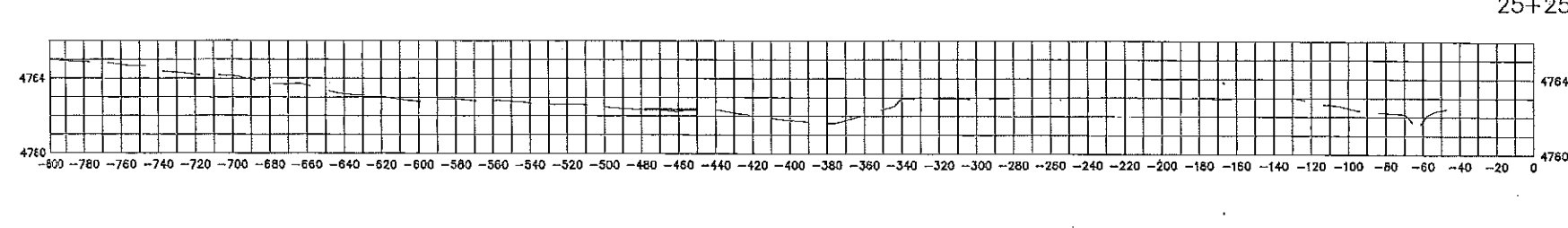
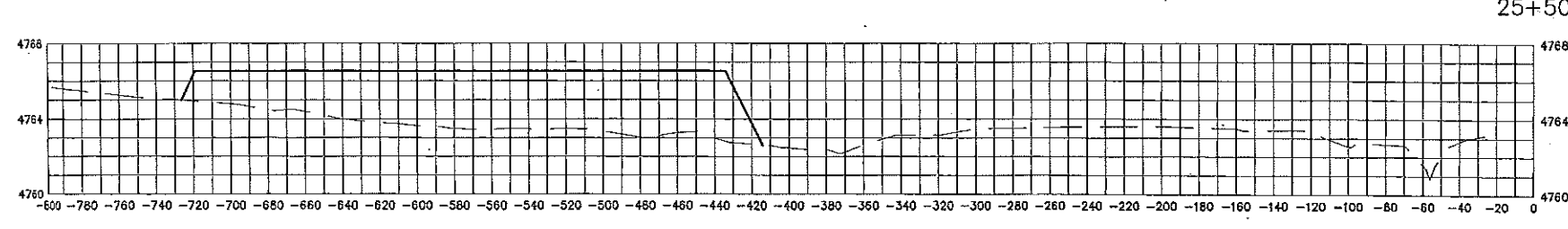
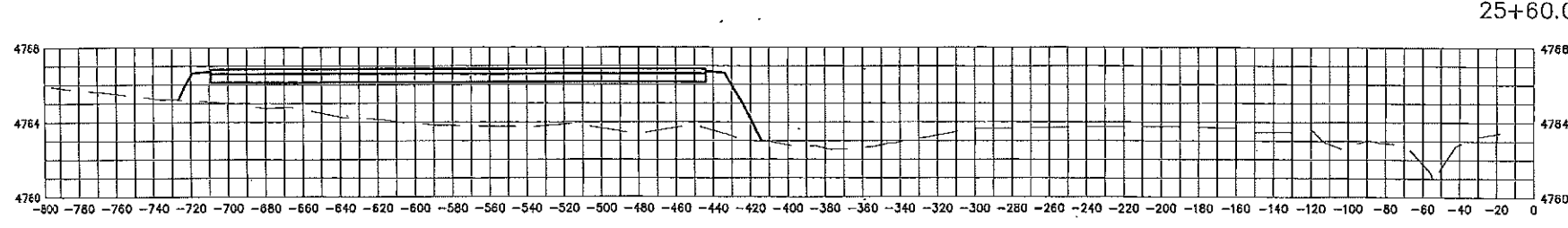
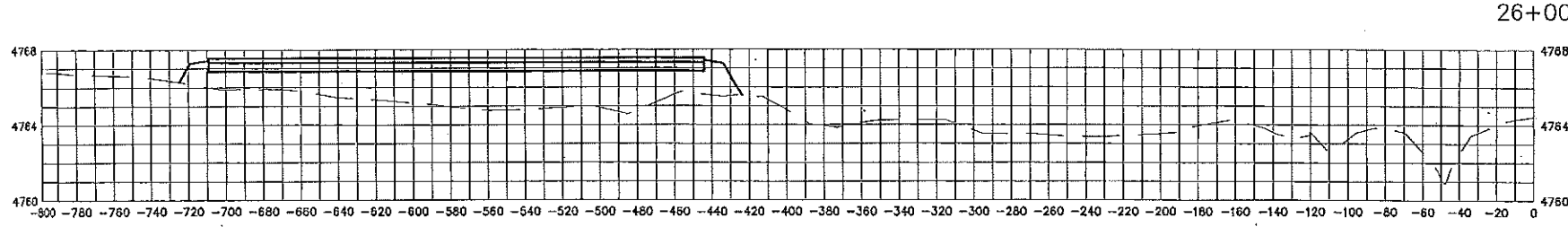

SEDONA AIRPORT
SEDONA, ARIZONA

SOUTHWEST APRON - PHASE I

CROSS SECTIONS

C&S Companies
9200 E. Pima Center Parkway, Ste 243
Scottsdale, Arizona 85258
Phone: (480) 997-7335
Fax: (480) 997-7332
www.cros.com

Professional Engineer
JESSICA L. HALLER
No. 10000
State of Arizona

Project No: 07045
Designed By: MG
Drawn By: MG
Checked By: LM
Date: 7-2011
Scale: AS SHOWN
Sheet: 12 OF 15

Layout: XS1
Exp: 9-30-11



PROJECT: SEDONA AIRPORT PHASE I - SW-SECTIONS - PHASE I.dwg
DATE: 07/20/11
DRAWN BY: LM

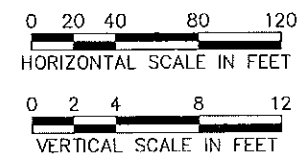
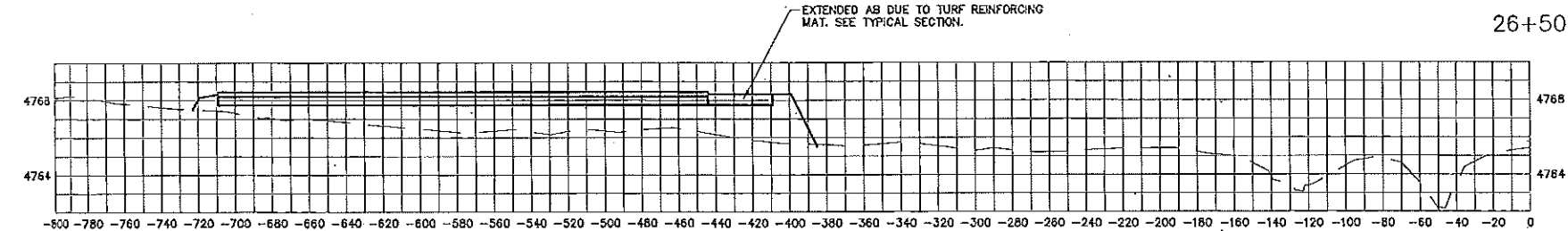
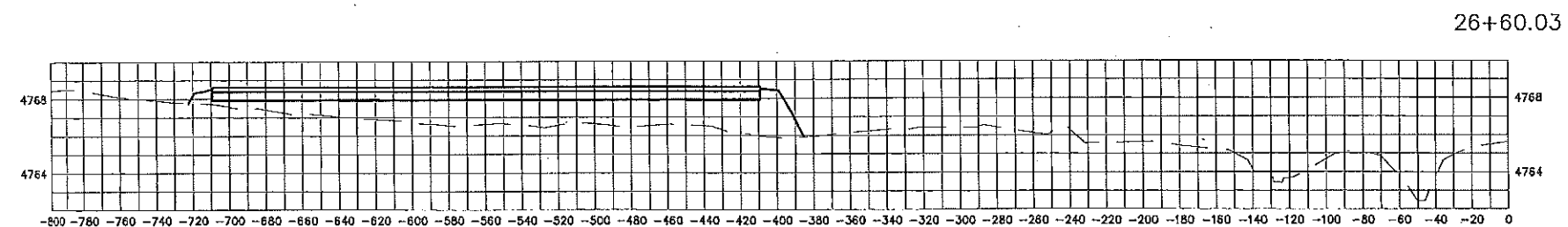
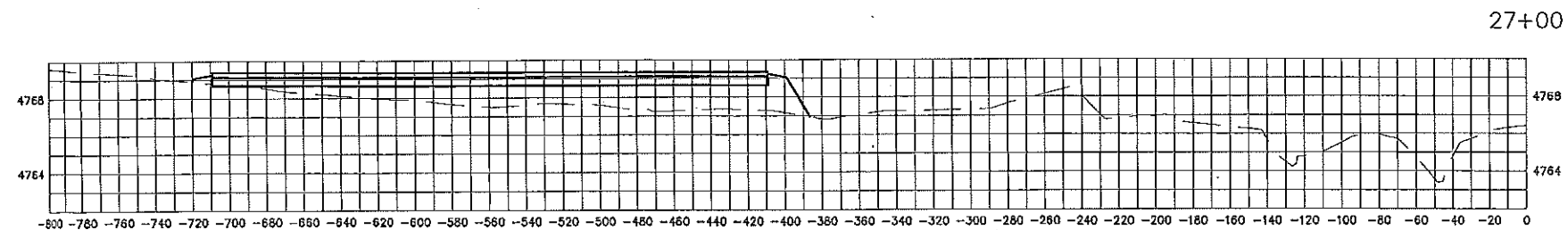
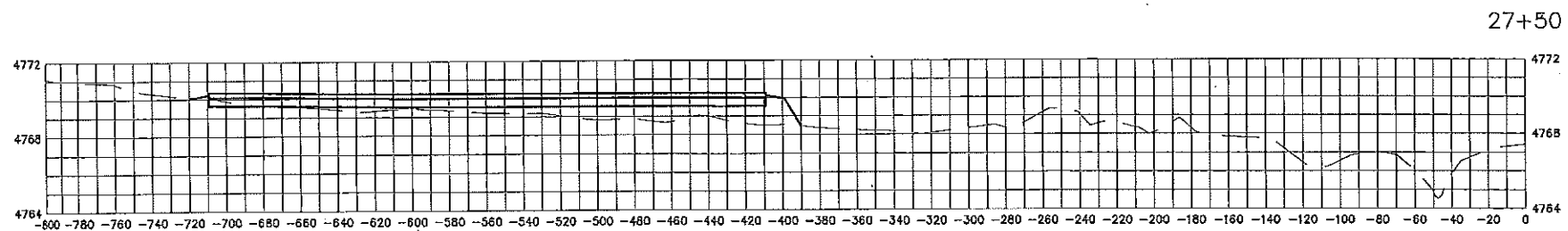

SEDONA AIRPORT
SEDONA, ARIZONA

SOUTHWEST APRON - PHASE I

CROSS SECTIONS



C&S Engineers, Inc.
9200 E. Plaza Center Parkway, Ste 240
Scottsdale, Arizona 85238
Phone: (602) 977-1536
Fax: (602) 977-1532
www.ccsai.com

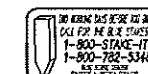

LAYOUT: XS2	DESIGNED BY: MG	DRAWN BY: MG	CHECKED BY: LM	DATE: 7-2011	SCALE: AS SHOWN	SHEET: 13 OF 15
-------------	-----------------	--------------	----------------	--------------	-----------------	-----------------

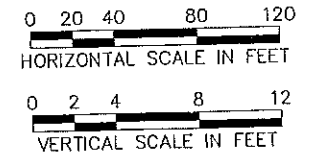
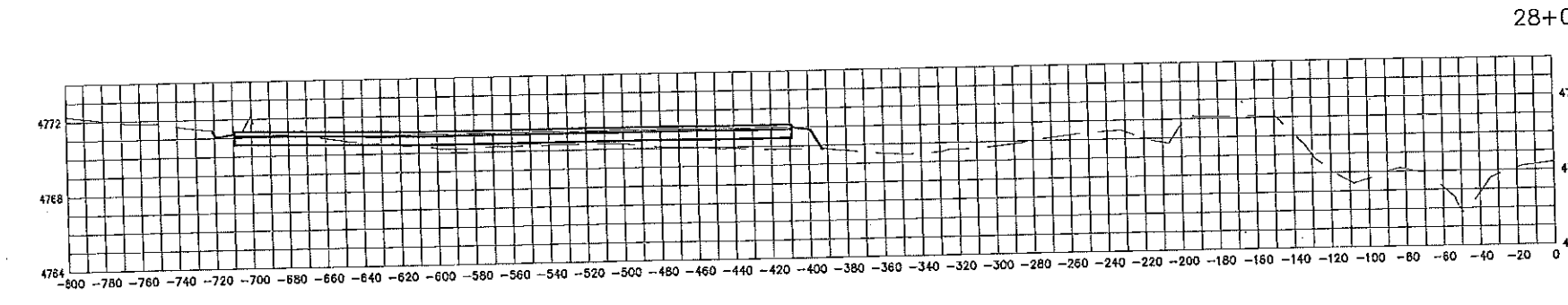
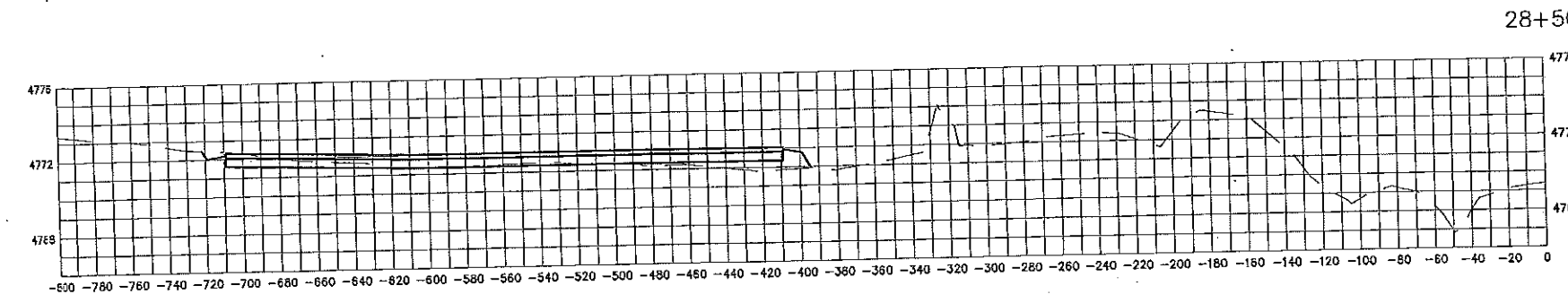
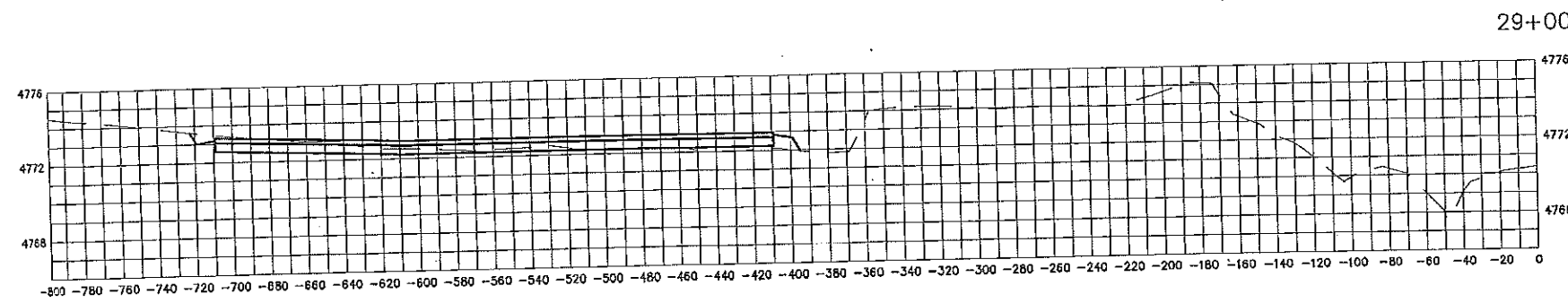
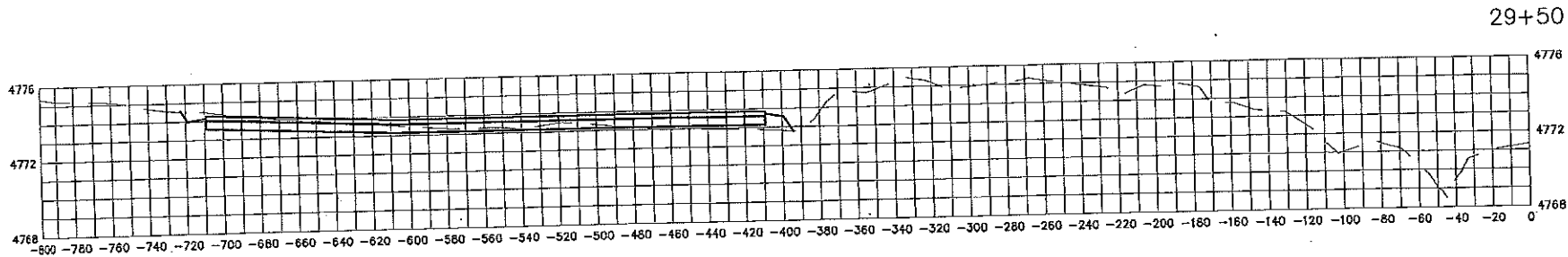

SEDONA AIRPORT
SEDONA, ARIZONA

SOUTHWEST APRON - PHASE I

CROSS SECTIONS

C&S COMPANIES, Inc.
9970 E. First Center Parkway, Ste 240
Scottsdale, Arizona 85258
Phone: (602) 997-7536
Fax: (602) 997-7592
www.ccs.com

4130A
JESSICA L. WALKER
Professional Engineer
No. 11117
State of Arizona

Exp: 9-30-11

PROJECT NO:	DESIGNED BY:	DRAWN BY:	CHECKED BY:	DATE:	SCALE:	SHEET:
07045	NG	NG	LM	7-2011	AS SHOWN	14 OF 15



07-25-2011 10:44 AM - JLS 07/25/11 10:44 AM
 C:\PROJECTS\SEDONA\APRON\PHASE I - CROSS SECTIONS TO X-SECTIONS - MADE LATER

