

SCAN QR CODE TO VISIT  
**APS CONSTRUCTION SERVICES**  
 WEBSITE

DATA MODIFIED PER FIELD CONDITIONS  
 VICINITY MAP

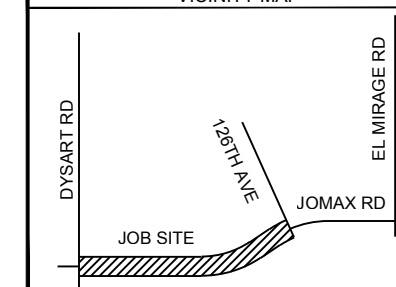

QUARTER SECTION GRID DATA

T4N	R1W	Sec 02 NE 1/4	MAP#
T5N	R1W	Sec 35 SE 1/4	MAP#
T	R	Sec 1/4	MAP#
T	R	Sec 1/4	MAP#
T	R	Sec 1/4	MAP#

CONTACT: RONNIE GANDARA  
 PHONE: MOBILE: 602-320-7069  
 INSPECTOR:  
 PHONE: MOBILE:

REVISION

DATE	DESCRIPTION	BY

**WA997728**  
**JOMAX RD EXTENSION**  
**DYSART RD TO 126TH DR**  
 FILE: WA997728.DWG  
 BY: ARUSI DATE: 03/30/2026  
 SCALE: 1:40 SHEET 2 OF 10

4/16/2026  
**DISCLAIMER**  
 BY ACCEPTING THIS DATA, RECIPIENT ACKNOWLEDGES AND AGREES TO THE FOLLOWING CONDITIONS:  
 • ALL DATA PROVIDED BY APS IS RESTRICTED TO USE AND REFERENCE ONLY TO THE SITE AND PROJECT FOR WHICH IT WAS ORIGINALLY PREPARED. ANY OTHER USES ARE PROHIBITED WITHOUT WRITTEN AUTHORIZATION FROM APS.  
 • ANY USE OF ELECTRONIC DATA RECEIVED FROM APS BY RECIPIENT SHALL BE AT THE RECIPIENT'S FULL RISK. RECIPIENT INDEMNIFIES AND HOLDS APS HARMLESS FROM DAMAGES, CLAIMS, OR LOSSES RESULTING FROM THE USE OF PROVIDED ELECTRONIC DATA. IN THE EVENT OF REQUIRED DEFENSE, RECIPIENT SHALL BE RESPONSIBLE FOR ANY AND ALL LEGAL EXPENSES AND ATTORNEYS' FEES. THE ELECTRONIC DATA RECEIVED FROM APS IS PROHIBITED FROM FURTHER DISTRIBUTION TO THIRD PARTIES WITHOUT WRITTEN AUTHORIZATION FROM APS.  
 • RECIPIENT ACKNOWLEDGES THAT CONSTRUCTION PLANS MAY BE UPDATED AND THE ELECTRONIC DATA PROVIDED HEREIN BY APS MAY BECOME OUTDATED. THE ELECTRONIC DATA SHALL NOT BE CONSIDERED "CONSTRUCTION DOCUMENTS". ALL DOCUMENTS CONSIDERED "CONSTRUCTION DOCUMENTS" SHALL BE HARD COPY ONLY AND IT IS RECIPIENT'S RESPONSIBILITY TO ASSURE THE ELECTRONIC DATA CONFORMS AND MATCHES THE LATEST SET OF CONSTRUCTION DOCUMENTS.  
 • IT IS THE RECIPIENT'S RESPONSIBILITY TO CONTACT BLUE STAKE PRIOR TO TRENCHING OR DIGGING. FAILURE TO CONTACT BLUE STAKE MAY RESULT IN VIOLATIONS OF A.R.S. §40-360.22 AND 40-360.23A  
 • BY SIGNING THIS APPROVED DOCUMENT, CUSTOMER ACKNOWLEDGES THAT ALL INFORMATION CONTAINED WITHIN THESE DRAWINGS ARE APS HIGHLY CONFIDENTIAL AND CUSTOMER ASSUMES FULL RESPONSIBILITY DUE TO ANY DEVIATIONS OR CHANGES WITHOUT WRITTEN CONSENT TO APS.

MATCHLINE: SEE ABOVE RIGHT

MATCHLINE: SEE BELOW LEFT

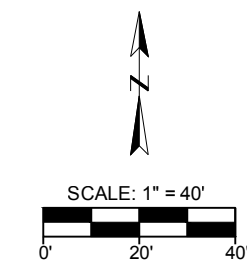

Contact Arizona 811 at least two full working days before you begin excavation

Call 811 or click Arizona811.com

4/16/2026 11:22 AM DESIGN DRAWING SHALL BE PRINTED ON "B" OR TABLOID/LEDGER SIZE (11"X17") PAPER.



NOT APPROVED FOR CONSTRUCTION  
**PRELIMINARY**  
 03/30/2026 — ARUSI

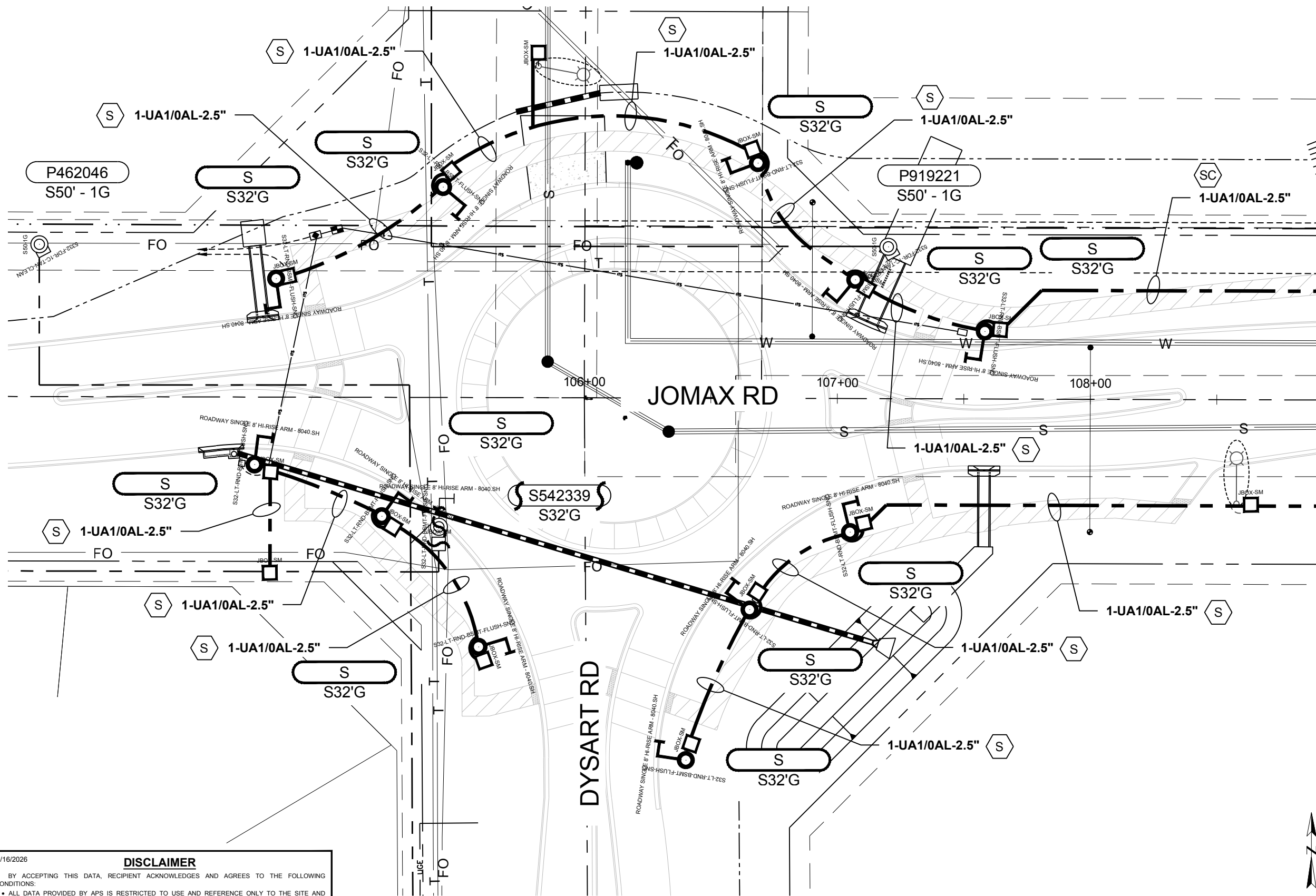

MATCHLINE A: SEE SHEET 4

SCAN QR CODE TO VISIT  
**APS CONSTRUCTION SERVICES**  
 WEBSITE

DATA MODIFIED PER FIELD CONDITIONS  
 VICINITY MAP

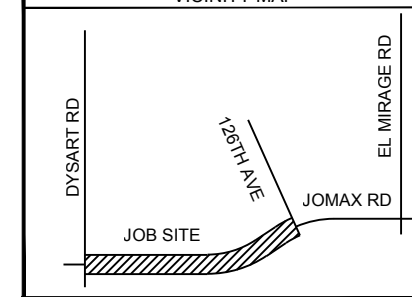

QUARTER SECTION GRID DATA

T4N	R1W	Sec 02 NE 1/4	MAP#
T5N	R1W	Sec 35 SE 1/4	MAP#
T	R	Sec 1/4	MAP#
T	R	Sec 1/4	MAP#
T	R	Sec 1/4	MAP#

CONTACT: RONNIE GANDARA  
 PHONE: MOBILE: 602-320-7069  
 INSPECTOR:  
 PHONE: MOBILE:

REVISION

DATE	DESCRIPTION	BY

4/16/2026  
**DISCLAIMER**  
 BY ACCEPTING THIS DATA, RECIPIENT ACKNOWLEDGES AND AGREES TO THE FOLLOWING CONDITIONS:  
 • ALL DATA PROVIDED BY APS IS RESTRICTED TO USE AND REFERENCE ONLY TO THE SITE AND PROJECT FOR WHICH IT WAS ORIGINALLY PREPARED. ANY OTHER USES ARE PROHIBITED WITHOUT WRITTEN AUTHORIZATION FROM APS.  
 • ANY USE OF ELECTRONIC DATA RECEIVED FROM APS BY RECIPIENT SHALL BE AT THE RECIPIENT'S FULL RISK. RECIPIENT INDEMNIFIES AND HOLDS APS HARMLESS FROM DAMAGES, CLAIMS, OR LOSSES RESULTING FROM THE USE OF PROVIDED ELECTRONIC DATA. IN THE EVENT OF REQUIRED DEFENSE, RECIPIENT SHALL BE RESPONSIBLE FOR ANY AND ALL LEGAL EXPENSES AND ATTORNEYS' FEES. THE ELECTRONIC DATA RECEIVED FROM APS IS PROHIBITED FROM FURTHER DISTRIBUTION TO THIRD PARTIES WITHOUT WRITTEN AUTHORIZATION FROM APS.  
 • RECIPIENT ACKNOWLEDGES THAT CONSTRUCTION PLANS MAY BE UPDATED AND THE ELECTRONIC DATA PROVIDED HEREIN BY APS MAY BECOME OUTDATED. THE ELECTRONIC DATA SHALL NOT BE CONSIDERED "CONSTRUCTION DOCUMENTS". ALL DOCUMENTS CONSIDERED "CONSTRUCTION DOCUMENTS" SHALL BE HARD COPY ONLY AND IT IS RECIPIENT'S RESPONSIBILITY TO ASSURE THE ELECTRONIC DATA CONFORMS AND MATCHES THE LATEST SET OF CONSTRUCTION DOCUMENTS.  
 • IT IS THE RECIPIENT'S RESPONSIBILITY TO CONTACT BLUE STAKE PRIOR TO TRENCHING OR DIGGING. FAILURE TO CONTACT BLUE STAKE MAY RESULT IN VIOLATIONS OF A.R.S. §40-360.22 AND 40-360.23A.  
 • BY SIGNING THIS APPROVED DOCUMENT, CUSTOMER ACKNOWLEDGES THAT ALL INFORMATION CONTAINED WITHIN THESE DRAWINGS ARE APS HIGHLY CONFIDENTIAL AND CUSTOMER ASSUMES FULL RESPONSIBILITY DUE TO ANY DEVIATIONS OR CHANGES WITHOUT WRITTEN CONSENT TO APS.

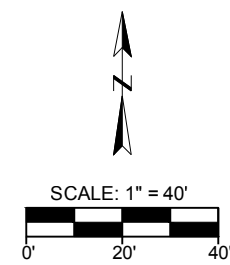

Contact Arizona 811 at least two full working days before you begin excavation

Call 811 or click Arizona811.com

**WA997728**  
**JOMAX RD EXTENSION**  
**DYASRT RD TO 126TH DR**  
 FILE: WA997728.DWG  
 BY: ARUSI DATE: 03/30/2026  
 SCALE: 1:40 SHEET 3 OF 10

4/16/2026 11:22 AM DESIGN DRAWING SHALL BE PRINTED ON "B" OR TABLOID/LEDGER SIZE (11"X17") PAPER.

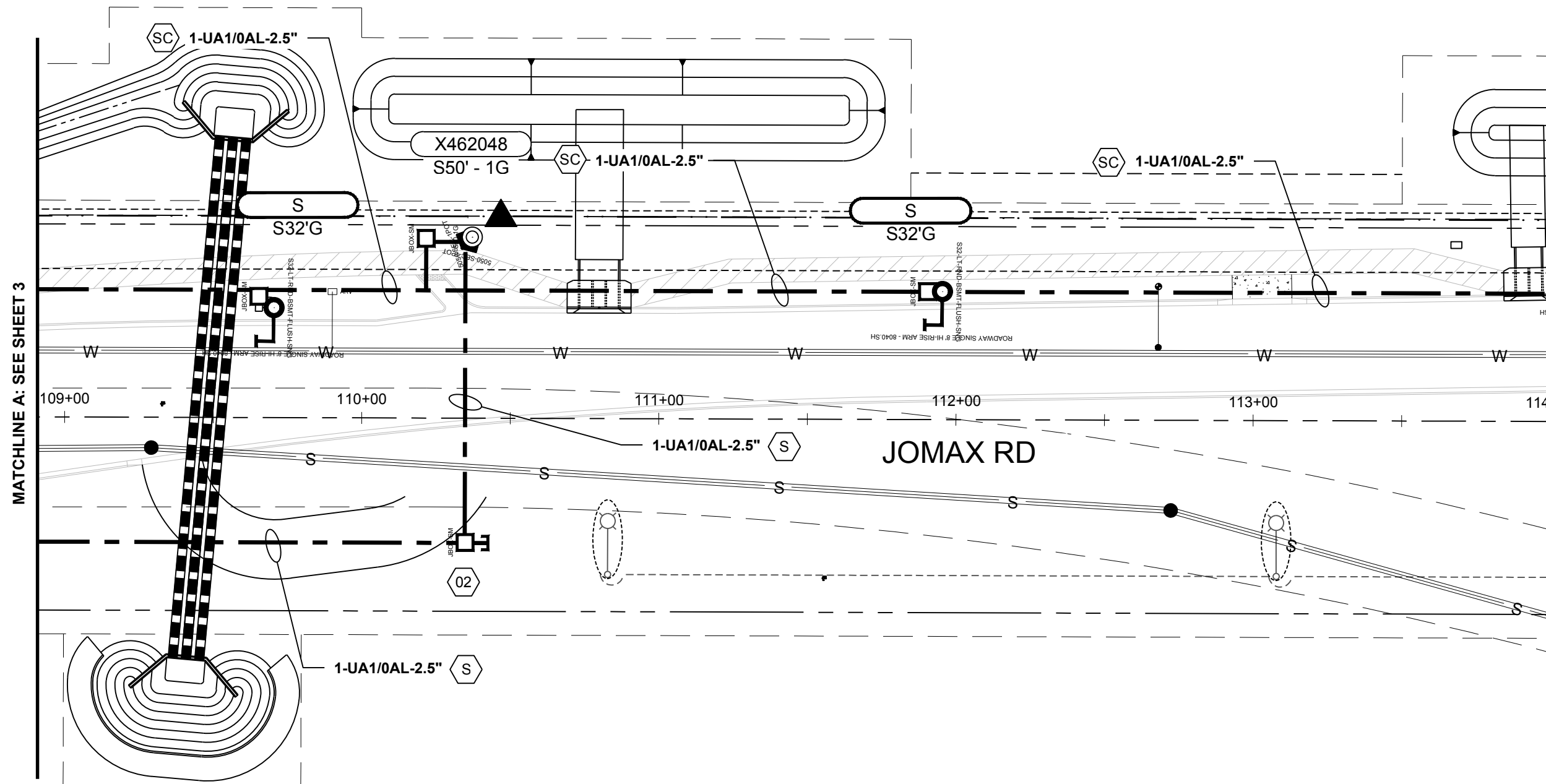

MATCHLINE A: SEE SHEET 3

MATCHLINE B: SEE SHEET 5

SCAN QR CODE TO VISIT  
**APS CONSTRUCTION SERVICES**  
 WEBSITE

DATA MODIFIED PER FIELD CONDITIONS

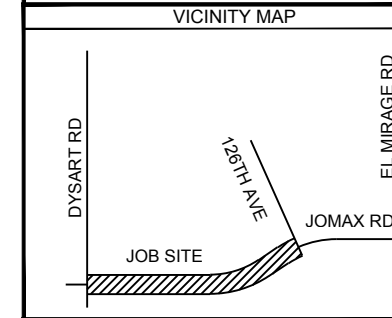

QUARTER SECTION GRID DATA			
T4N	R1W	Sec 02 NE 1/4	MAP#
T5N	R1W	Sec 35 SE 1/4	MAP#
T	R	Sec 1/4	MAP#
T	R	Sec 1/4	MAP#
T	R	Sec 1/4	MAP#

CONTACT: RONNIE GANDARA  
 PHONE: MOBILE: 602-320-7069  
 INSPECTOR:  
 PHONE: MOBILE:

REVISION		

DATE	DESCRIPTION	BY

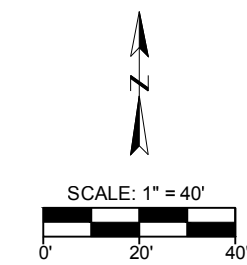

4/16/2026

**DISCLAIMER**

BY ACCEPTING THIS DATA, RECIPIENT ACKNOWLEDGES AND AGREES TO THE FOLLOWING CONDITIONS:

- ALL DATA PROVIDED BY APS IS RESTRICTED TO USE AND REFERENCE ONLY TO THE SITE AND PROJECT FOR WHICH IT WAS ORIGINALLY PREPARED. ANY OTHER USES ARE PROHIBITED WITHOUT WRITTEN AUTHORIZATION FROM APS.
- ANY USE OF ELECTRONIC DATA RECEIVED FROM APS BY RECIPIENT SHALL BE AT THE RECIPIENT'S FULL RISK. RECIPIENT INDEMNIFIES AND HOLDS APS HARMLESS FROM DAMAGES, CLAIMS, OR LOSSES RESULTING FROM THE USE OF PROVIDED ELECTRONIC DATA. IN THE EVENT OF REQUIRED DEFENSE, RECIPIENT SHALL BE RESPONSIBLE FOR ANY AND ALL LEGAL EXPENSES AND ATTORNEYS' FEES. THE ELECTRONIC DATA RECEIVED FROM APS IS PROHIBITED FROM FURTHER DISTRIBUTION TO THIRD PARTIES WITHOUT WRITTEN AUTHORIZATION FROM APS.
- RECIPIENT ACKNOWLEDGES THAT CONSTRUCTION PLANS MAY BE UPDATED AND THE ELECTRONIC DATA PROVIDED HEREIN BY APS MAY BECOME OUTDATED. THE ELECTRONIC DATA SHALL NOT BE CONSIDERED "CONSTRUCTION DOCUMENTS". ALL DOCUMENTS CONSIDERED "CONSTRUCTION DOCUMENTS" SHALL BE HARD COPY ONLY AND IT IS RECIPIENT'S RESPONSIBILITY TO ASSURE THE ELECTRONIC DATA CONFORMS AND MATCHES THE LATEST SET OF CONSTRUCTION DOCUMENTS.
- IT IS THE RECIPIENT'S RESPONSIBILITY TO CONTACT BLUE STAKE PRIOR TO TRENCHING OR DIGGING. FAILURE TO CONTACT BLUE STAKE MAY RESULT IN VIOLATIONS OF A.R.S. §40-360.22 AND 40-360.23A
- BY SIGNING THIS APPROVED DOCUMENT, CUSTOMER ACKNOWLEDGES THAT ALL INFORMATION CONTAINED WITHIN THESE DRAWINGS ARE APS HIGHLY CONFIDENTIAL AND CUSTOMER ASSUMES FULL RESPONSIBILITY DUE TO ANY DEVIATIONS OR CHANGES WITHOUT WRITTEN CONSENT TO APS.

Contact Arizona 811 at least two full working days before you begin excavation

Call 811 or click Arizona811.com

**WA997728**  
**JOMAX RD EXTENSION**  
**DYASRT RD TO 126TH DR**

FILE: WA997728.DWG  
 BY: ARUSI DATE: 03/30/2026  
 SCALE: 1:40 SHEET 4 OF 10

4/16/2026 11:22 AM DESIGN DRAWING SHALL BE PRINTED ON "B" OR TABLOID/LEDGER SIZE (11"X17") PAPER.

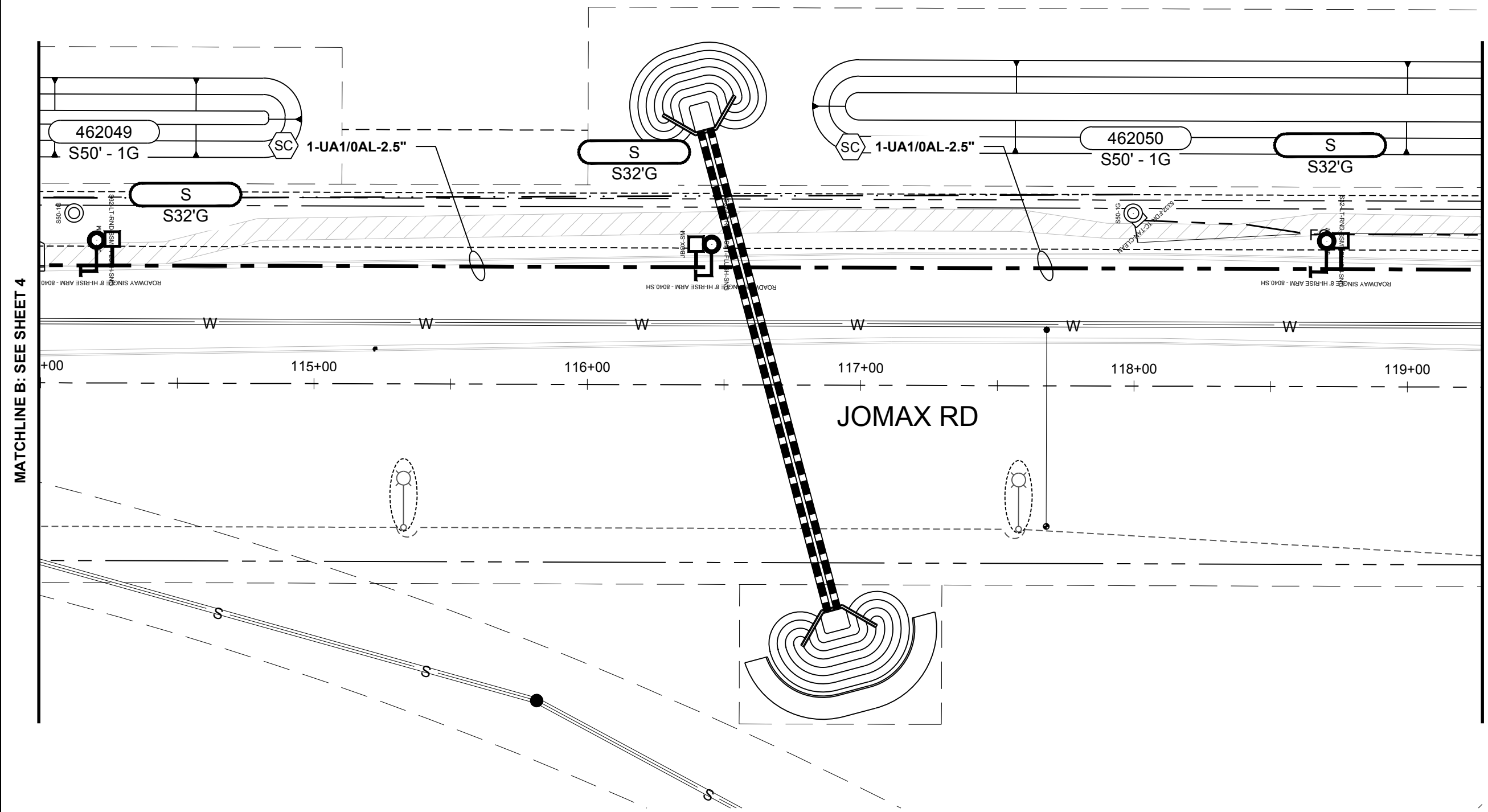

MATCHLINE B: SEE SHEET 4

MATCHLINE C: SEE SHEET 6

SCAN QR CODE TO VISIT  
**APS CONSTRUCTION SERVICES**  
 WEBSITE

**DATA MODIFIED PER FIELD CONDITIONS**

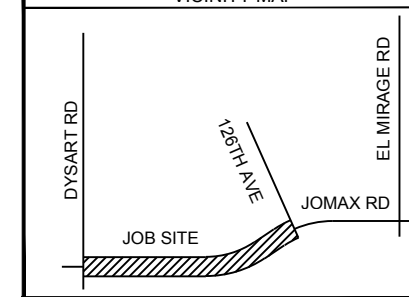

**QUARTER SECTION GRID DATA**

T4N	R1W	Sec 02 NE 1/4	MAP#
T5N	R1W	Sec 35 SE 1/4	MAP#
T	R	Sec 1/4	MAP#
T	R	Sec 1/4	MAP#
T	R	Sec 1/4	MAP#

CONTACT: RONNIE GANDARA  
 PHONE: MOBILE: 602-320-7069  
 INSPECTOR:  
 PHONE: MOBILE:

**REVISION**

DATE	DESCRIPTION	BY

4/16/2026  
**DISCLAIMER**  
 BY ACCEPTING THIS DATA, RECIPIENT ACKNOWLEDGES AND AGREES TO THE FOLLOWING CONDITIONS:  
 • ALL DATA PROVIDED BY APS IS RESTRICTED TO USE AND REFERENCE ONLY TO THE SITE AND PROJECT FOR WHICH IT WAS ORIGINALLY PREPARED. ANY OTHER USES ARE PROHIBITED WITHOUT WRITTEN AUTHORIZATION FROM APS.  
 • ANY USE OF ELECTRONIC DATA RECEIVED FROM APS BY RECIPIENT SHALL BE AT THE RECIPIENT'S FULL RISK. RECIPIENT INDEMNIFIES AND HOLDS APS HARMLESS FROM DAMAGES, CLAIMS, OR LOSSES RESULTING FROM THE USE OF PROVIDED ELECTRONIC DATA. IN THE EVENT OF REQUIRED DEFENSE, RECIPIENT SHALL BE RESPONSIBLE FOR ANY AND ALL LEGAL EXPENSES AND ATTORNEYS' FEES. THE ELECTRONIC DATA RECEIVED FROM APS IS PROHIBITED FROM FURTHER DISTRIBUTION TO THIRD PARTIES WITHOUT WRITTEN AUTHORIZATION FROM APS.  
 • RECIPIENT ACKNOWLEDGES THAT CONSTRUCTION PLANS MAY BE UPDATED AND THE ELECTRONIC DATA PROVIDED HEREIN BY APS MAY BECOME OUTDATED. THE ELECTRONIC DATA SHALL NOT BE CONSIDERED "CONSTRUCTION DOCUMENTS". ALL DOCUMENTS CONSIDERED "CONSTRUCTION DOCUMENTS" SHALL BE HARD COPY ONLY AND IT IS RECIPIENT'S RESPONSIBILITY TO ASSURE THE ELECTRONIC DATA CONFORMS AND MATCHES THE LATEST SET OF CONSTRUCTION DOCUMENTS.  
 • IT IS THE RECIPIENT'S RESPONSIBILITY TO CONTACT BLUE STAKE PRIOR TO TRENCHING OR DIGGING. FAILURE TO CONTACT BLUE STAKE MAY RESULT IN VIOLATIONS OF A.R.S. §40-360.22 AND 40-360.23A  
 • BY SIGNING THIS APPROVED DOCUMENT, CUSTOMER ACKNOWLEDGES THAT ALL INFORMATION CONTAINED WITHIN THESE DRAWINGS ARE APS HIGHLY CONFIDENTIAL AND CUSTOMER ASSUMES FULL RESPONSIBILITY DUE TO ANY DEVIATIONS OR CHANGES WITHOUT WRITTEN CONSENT TO APS.

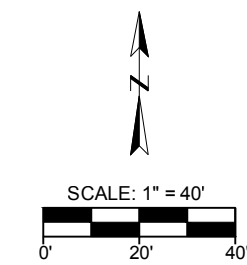

Contact Arizona 811 at least two full working days before you begin excavation

Call 811 or click Arizona811.com

**WA997728**  
**JOMAX RD EXTENSION**  
**DYSART RD TO 126TH DR**  
 FILE: WA997728.DWG  
 BY: ARUSI DATE: 03/30/2026  
 SCALE: 1:40 SHEET 5 OF 10

4/16/2026 11:22 AM DESIGN DRAWING SHALL BE PRINTED ON "B" OR TABLOID/LEDGER SIZE (11"X17") PAPER.

NOT APPROVED FOR CONSTRUCTION  
**PRELIMINARY**  
 03/30/2026 ARUSI

MATCHLINE C: SEE SHEET 5

MATCHLINE D: SEE SHEET 7

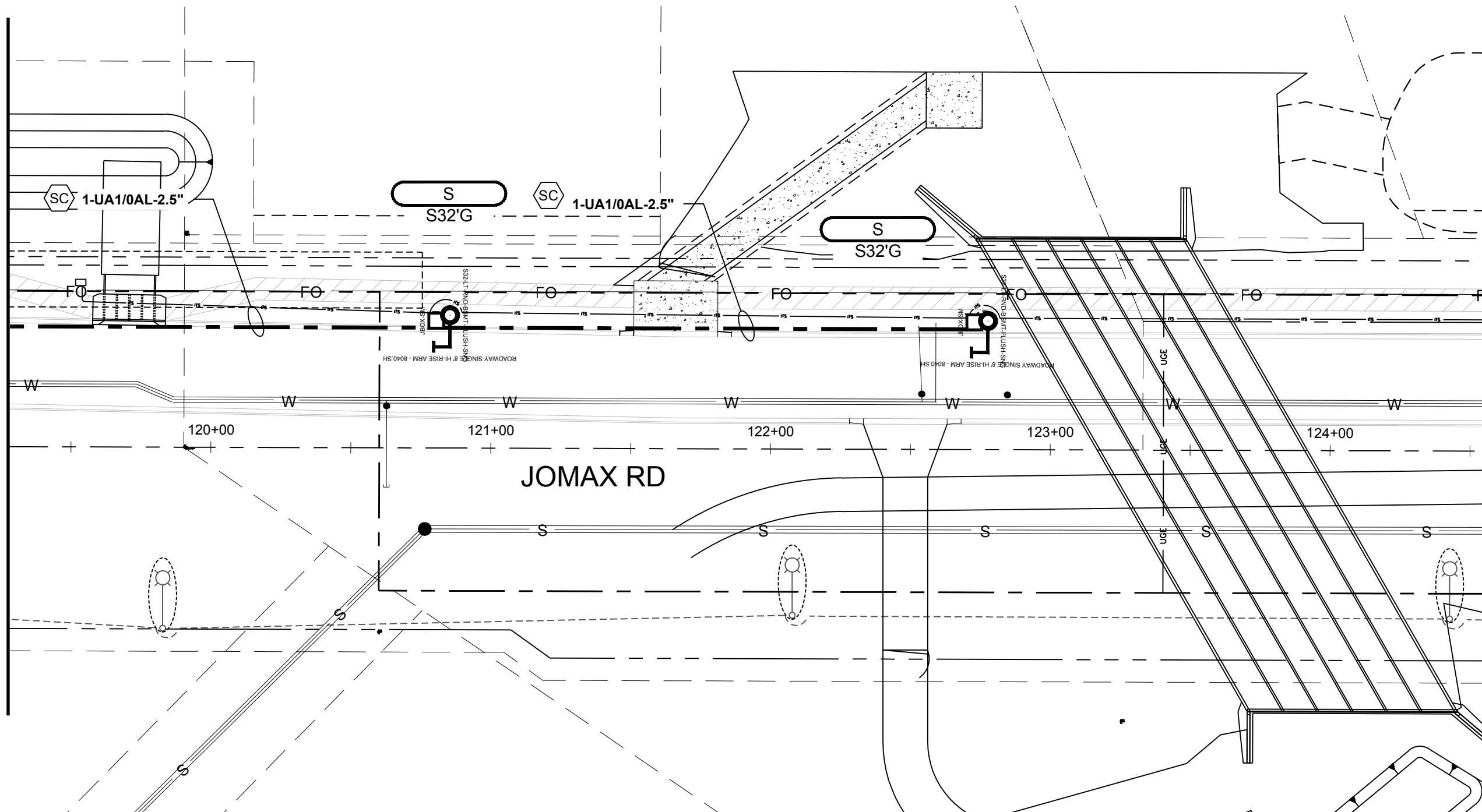

SCAN QR CODE TO VISIT  
**APS CONSTRUCTION SERVICES**  
 WEBSITE

DATA MODIFIED PER FIELD CONDITIONS  
 VICINITY MAP

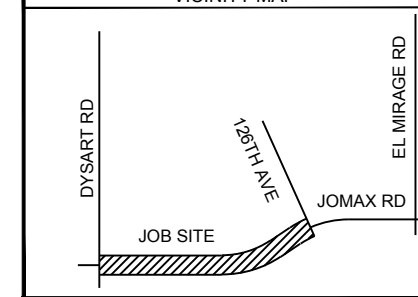

QUARTER SECTION GRID DATA

T4N	R1W	Sec 02 NE 1/4	MAP#
T5N	R1W	Sec 35 SE 1/4	MAP#
T	R	Sec 1/4	MAP#
T	R	Sec 1/4	MAP#
T	R	Sec 1/4	MAP#

CONTACT: RONNIE GANDARA  
 PHONE: MOBILE: 602-320-7069  
 INSPECTOR:  
 PHONE: MOBILE:

REVISION

DATE	DESCRIPTION	BY

4/16/2026  
**DISCLAIMER**  
 BY ACCEPTING THIS DATA, RECIPIENT ACKNOWLEDGES AND AGREES TO THE FOLLOWING CONDITIONS:  
 • ALL DATA PROVIDED BY APS IS RESTRICTED TO USE AND REFERENCE ONLY TO THE SITE AND PROJECT FOR WHICH IT WAS ORIGINALLY PREPARED. ANY OTHER USES ARE PROHIBITED WITHOUT WRITTEN AUTHORIZATION FROM APS.  
 • ANY USE OF ELECTRONIC DATA RECEIVED FROM APS BY RECIPIENT SHALL BE AT THE RECIPIENT'S FULL RISK. RECIPIENT INDEMNIFIES AND HOLDS APS HARMLESS FROM DAMAGES, CLAIMS, OR LOSSES RESULTING FROM THE USE OF PROVIDED ELECTRONIC DATA. IN THE EVENT OF REQUIRED DEFENSE, RECIPIENT SHALL BE RESPONSIBLE FOR ANY AND ALL LEGAL EXPENSES AND ATTORNEYS' FEES. THE ELECTRONIC DATA RECEIVED FROM APS IS PROHIBITED FROM FURTHER DISTRIBUTION TO THIRD PARTIES WITHOUT WRITTEN AUTHORIZATION FROM APS.  
 • RECIPIENT ACKNOWLEDGES THAT CONSTRUCTION PLANS MAY BE UPDATED AND THE ELECTRONIC DATA PROVIDED HEREIN BY APS MAY BECOME OUTDATED. THE ELECTRONIC DATA SHALL NOT BE CONSIDERED "CONSTRUCTION DOCUMENTS". ALL DOCUMENTS CONSIDERED "CONSTRUCTION DOCUMENTS" SHALL BE HARD COPY ONLY AND IT IS RECIPIENT'S RESPONSIBILITY TO ASSURE THE ELECTRONIC DATA CONFORMS AND MATCHES THE LATEST SET OF CONSTRUCTION DOCUMENTS.  
 • IT IS THE RECIPIENT'S RESPONSIBILITY TO CONTACT BLUE STAKE PRIOR TO TRENCHING OR DIGGING. FAILURE TO CONTACT BLUE STAKE MAY RESULT IN VIOLATIONS OF A.R.S. §40-360.22 AND 40-360.23A  
 • BY SIGNING THIS APPROVED DOCUMENT, CUSTOMER ACKNOWLEDGES THAT ALL INFORMATION CONTAINED WITHIN THESE DRAWINGS ARE APS HIGHLY CONFIDENTIAL AND CUSTOMER ASSUMES FULL RESPONSIBILITY DUE TO ANY DEVIATIONS OR CHANGES WITHOUT WRITTEN CONSENT TO APS.

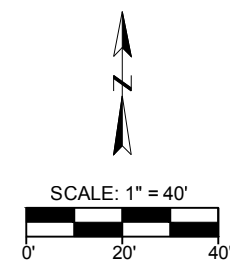

Contact Arizona 811 at least two full working days before you begin excavation

Call 811 or click Arizona811.com

**WA997728**  
**JOMAX RD EXTENSION**  
**DYASRT RD TO 126TH DR**  
 FILE: WA997728.DWG  
 BY: ARUSI DATE: 03/30/2026  
 SCALE: 1:40 SHEET 6 OF 10

4/16/2026 11:22 AM DESIGN DRAWING SHALL BE PRINTED ON "B" OR TABLOID/LEDGER SIZE (11"X17") PAPER.

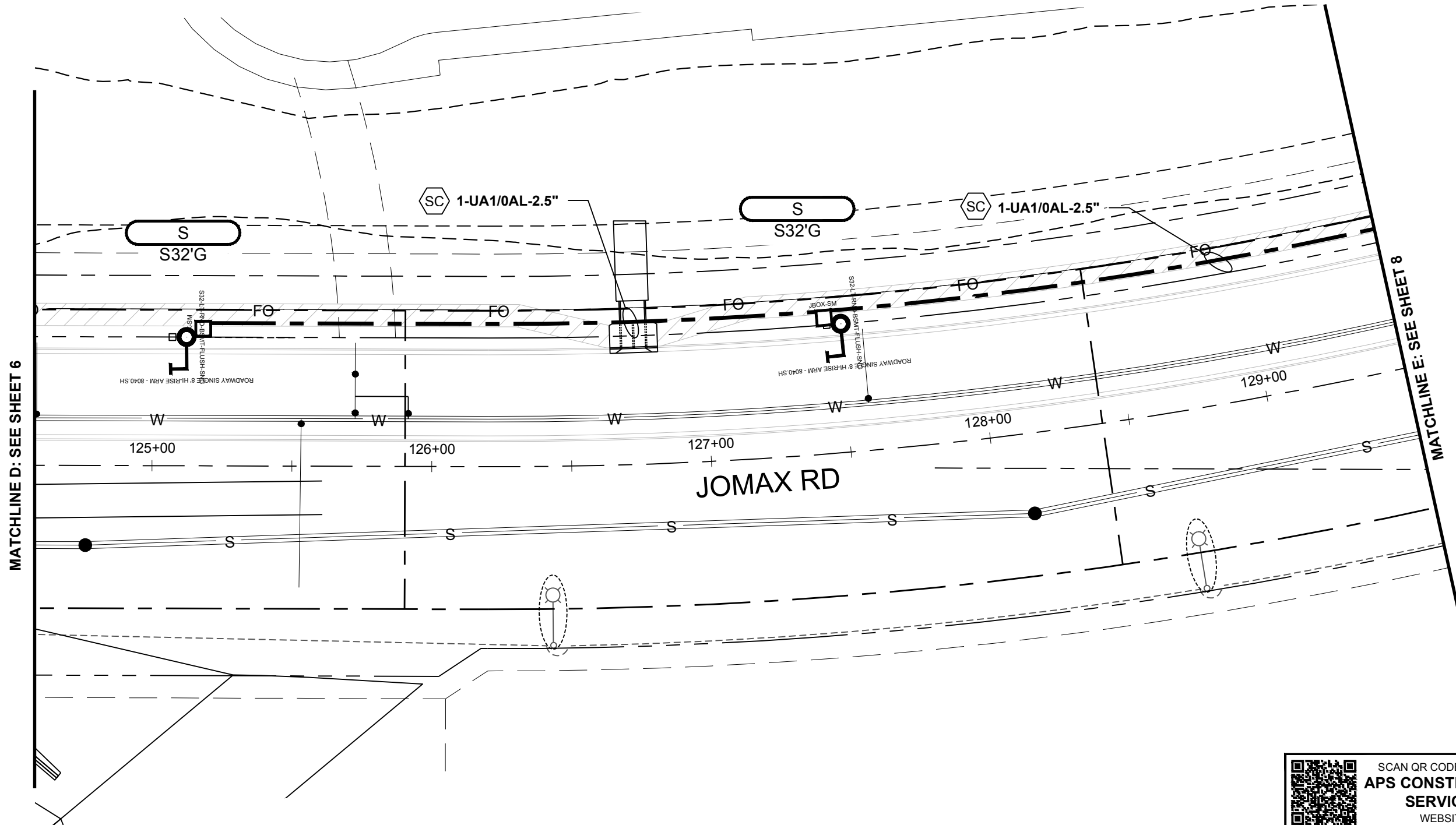

MATCHLINE D: SEE SHEET 6

MATCHLINE E: SEE SHEET 8

SCAN QR CODE TO VISIT  
**APS CONSTRUCTION SERVICES**  
 WEBSITE

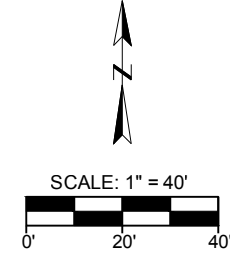

**DATA MODIFIED PER FIELD CONDITIONS**

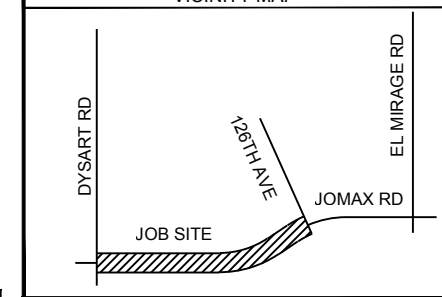

QUARTER SECTION GRID DATA

T4N	R1W	Sec 02 NE 1/4	MAP#
T5N	R1W	Sec 35 SE 1/4	MAP#
T	R	Sec 1/4	MAP#
T	R	Sec 1/4	MAP#
T	R	Sec 1/4	MAP#

CONTACT: RONNIE GANDARA  
 PHONE: MOBILE: 602-320-7069  
 INSPECTOR:  
 PHONE: MOBILE:

REVISION

DATE	DESCRIPTION	BY

**WA997728**  
**JOMAX RD EXTENSION**  
**DYSART RD TO 126TH DR**  
 FILE: WA997728.DWG  
 BY: ARUSI DATE: 03/30/2026  
 SCALE: 1:40 SHEET 7 OF 10

4/16/2026

**DISCLAIMER**

BY ACCEPTING THIS DATA, RECIPIENT ACKNOWLEDGES AND AGREES TO THE FOLLOWING CONDITIONS:

- ALL DATA PROVIDED BY APS IS RESTRICTED TO USE AND REFERENCE ONLY TO THE SITE AND PROJECT FOR WHICH IT WAS ORIGINALLY PREPARED. ANY OTHER USES ARE PROHIBITED WITHOUT WRITTEN AUTHORIZATION FROM APS.
- ANY USE OF ELECTRONIC DATA RECEIVED FROM APS BY RECIPIENT SHALL BE AT THE RECIPIENT'S FULL RISK. RECIPIENT INDEMNIFIES AND HOLDS APS HARMLESS FROM DAMAGES, CLAIMS, OR LOSSES RESULTING FROM THE USE OF PROVIDED ELECTRONIC DATA. IN THE EVENT OF REQUIRED DEFENSE, RECIPIENT SHALL BE RESPONSIBLE FOR ANY AND ALL LEGAL EXPENSES AND ATTORNEYS' FEES. THE ELECTRONIC DATA RECEIVED FROM APS IS PROHIBITED FROM FURTHER DISTRIBUTION TO THIRD PARTIES WITHOUT WRITTEN AUTHORIZATION FROM APS.
- RECIPIENT ACKNOWLEDGES THAT CONSTRUCTION PLANS MAY BE UPDATED AND THE ELECTRONIC DATA PROVIDED HEREIN BY APS MAY BECOME OUTDATED. THE ELECTRONIC DATA SHALL NOT BE CONSIDERED "CONSTRUCTION DOCUMENTS". ALL DOCUMENTS CONSIDERED "CONSTRUCTION DOCUMENTS" SHALL BE HARD COPY ONLY AND IT IS RECIPIENT'S RESPONSIBILITY TO ASSURE THE ELECTRONIC DATA CONFORMS AND MATCHES THE LATEST SET OF CONSTRUCTION DOCUMENTS.
- IT IS THE RECIPIENT'S RESPONSIBILITY TO CONTACT BLUE STAKE PRIOR TO TRENCHING OR DIGGING. FAILURE TO CONTACT BLUE STAKE MAY RESULT IN VIOLATIONS OF A.R.S. §40-360.22 AND 40-360.23A
- BY SIGNING THIS APPROVED DOCUMENT, CUSTOMER ACKNOWLEDGES THAT ALL INFORMATION CONTAINED WITHIN THESE DRAWINGS ARE APS HIGHLY CONFIDENTIAL AND CUSTOMER ASSUMES FULL RESPONSIBILITY DUE TO ANY DEVIATIONS OR CHANGES WITHOUT WRITTEN CONSENT TO APS.

Contact Arizona 811 at least two full working days before you begin excavation

Call 811 or click Arizona811.com

4/16/2026 11:22 AM DESIGN DRAWING SHALL BE PRINTED ON "B" OR TABLOID/LEDGER SIZE (11"X17") PAPER.

NOT APPROVED FOR CONSTRUCTION  
**PRELIMINARY**  
 03/30/2026 ARUSI

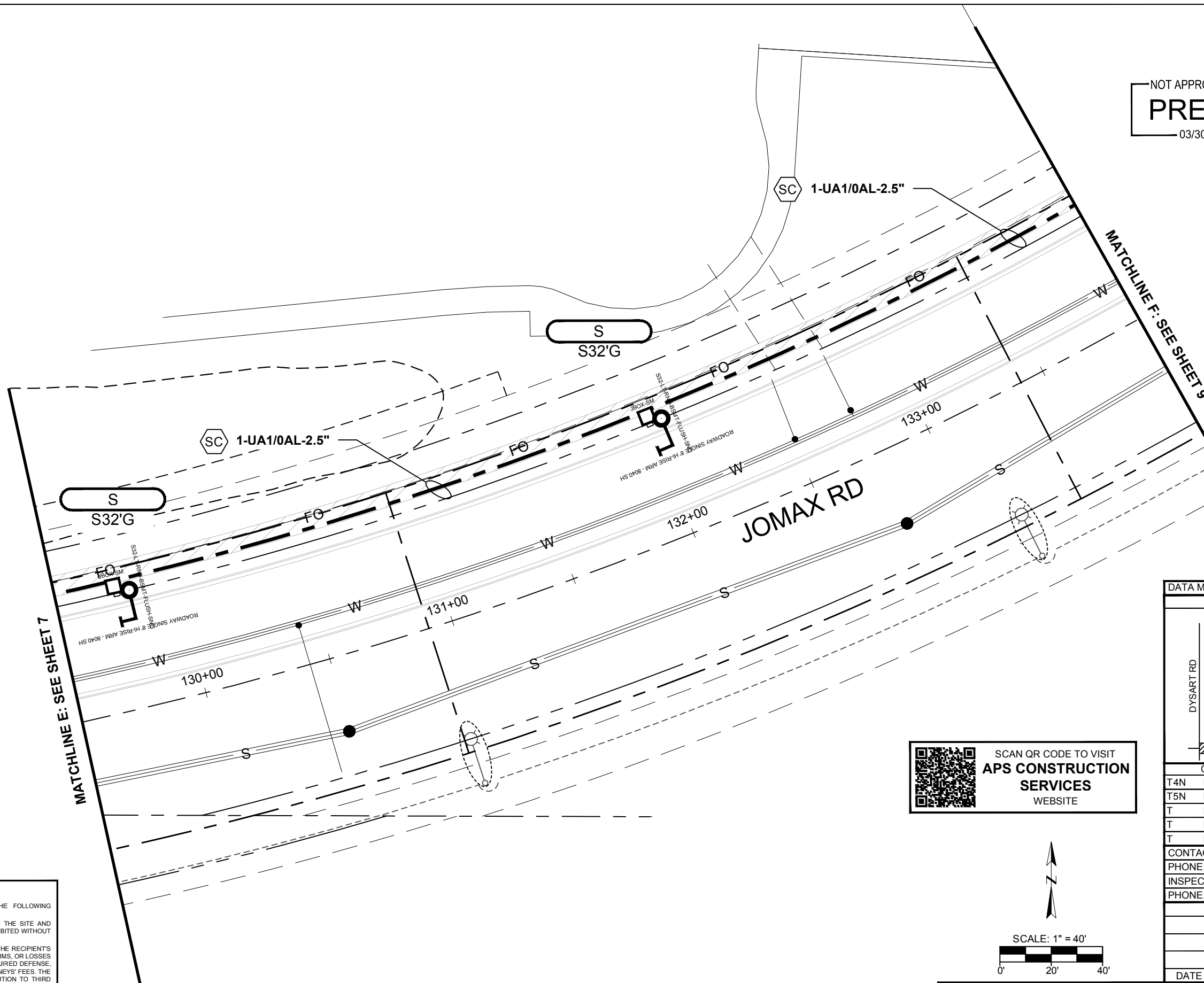

MATCHLINE E: SEE SHEET 7

MATCHLINE F: SEE SHEET 9

DATA MODIFIED PER FIELD CONDITIONS

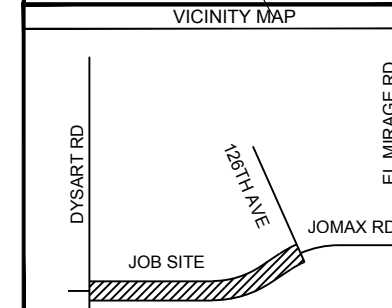

QUARTER SECTION GRID DATA			
T4N	R1W	Sec 02 NE 1/4	MAP#
T5N	R1W	Sec 35 SE 1/4	MAP#
T	R	Sec 1/4	MAP#
T	R	Sec 1/4	MAP#
T	R	Sec 1/4	MAP#

CONTACT: RONNIE GANDARA  
 PHONE: MOBILE: 602-320-7069  
 INSPECTOR:  
 PHONE: MOBILE:

REVISION		

DATE	DESCRIPTION	BY

SCAN QR CODE TO VISIT  
**APS CONSTRUCTION SERVICES**  
 WEBSITE

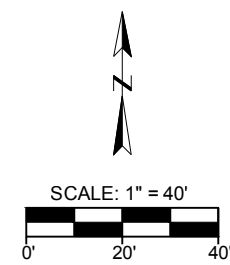

4/16/2026

**DISCLAIMER**

BY ACCEPTING THIS DATA, RECIPIENT ACKNOWLEDGES AND AGREES TO THE FOLLOWING CONDITIONS:

- ALL DATA PROVIDED BY APS IS RESTRICTED TO USE AND REFERENCE ONLY TO THE SITE AND PROJECT FOR WHICH IT WAS ORIGINALLY PREPARED. ANY OTHER USES ARE PROHIBITED WITHOUT WRITTEN AUTHORIZATION FROM APS.
- ANY USE OF ELECTRONIC DATA RECEIVED FROM APS BY RECIPIENT SHALL BE AT THE RECIPIENT'S FULL RISK. RECIPIENT INDEMNIFIES AND HOLDS APS HARMLESS FROM DAMAGES, CLAIMS, OR LOSSES RESULTING FROM THE USE OF PROVIDED ELECTRONIC DATA. IN THE EVENT OF REQUIRED DEFENSE, RECIPIENT SHALL BE RESPONSIBLE FOR ANY AND ALL LEGAL EXPENSES AND ATTORNEYS' FEES. THE ELECTRONIC DATA RECEIVED FROM APS IS PROHIBITED FROM FURTHER DISTRIBUTION TO THIRD PARTIES WITHOUT WRITTEN AUTHORIZATION FROM APS.
- RECIPIENT ACKNOWLEDGES THAT CONSTRUCTION PLANS MAY BE UPDATED AND THE ELECTRONIC DATA PROVIDED HEREIN BY APS MAY BECOME OUTDATED. THE ELECTRONIC DATA SHALL NOT BE CONSIDERED "CONSTRUCTION DOCUMENTS". ALL DOCUMENTS CONSIDERED "CONSTRUCTION DOCUMENTS" SHALL BE HARD COPY ONLY AND IT IS RECIPIENT'S RESPONSIBILITY TO ASSURE THE ELECTRONIC DATA CONFORMS AND MATCHES THE LATEST SET OF CONSTRUCTION DOCUMENTS.
- IT IS THE RECIPIENT'S RESPONSIBILITY TO CONTACT BLUE STAKE PRIOR TO TRENCHING OR DIGGING. FAILURE TO CONTACT BLUE STAKE MAY RESULT IN VIOLATIONS OF A.R.S. §40-360.22 AND 40-360.23A
- BY SIGNING THIS APPROVED DOCUMENT, CUSTOMER ACKNOWLEDGES THAT ALL INFORMATION CONTAINED WITHIN THESE DRAWINGS ARE APS HIGHLY CONFIDENTIAL AND CUSTOMER ASSUMES FULL RESPONSIBILITY DUE TO ANY DEVIATIONS OR CHANGES WITHOUT WRITTEN CONSENT TO APS.

Contact Arizona 811 at least two full working days before you begin excavation

Call 811 or click Arizona811.com

**WA997728**  
**JOMAX RD EXTENSION**  
**DYASRT RD TO 126TH DR**

FILE: WA997728.DWG  
 BY: ARUSI DATE: 03/30/2026  
 SCALE: 1:40 SHEET 8 OF 10

4/16/2026 11:22 AM DESIGN DRAWING SHALL BE PRINTED ON "B" OR TABLOID/LEDGER SIZE (11"X17") PAPER.



NOT APPROVED FOR CONSTRUCTION  
**PRELIMINARY**  
 03/30/2026 ARUSI

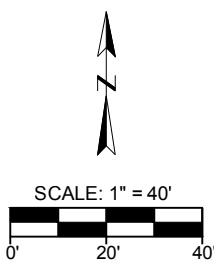
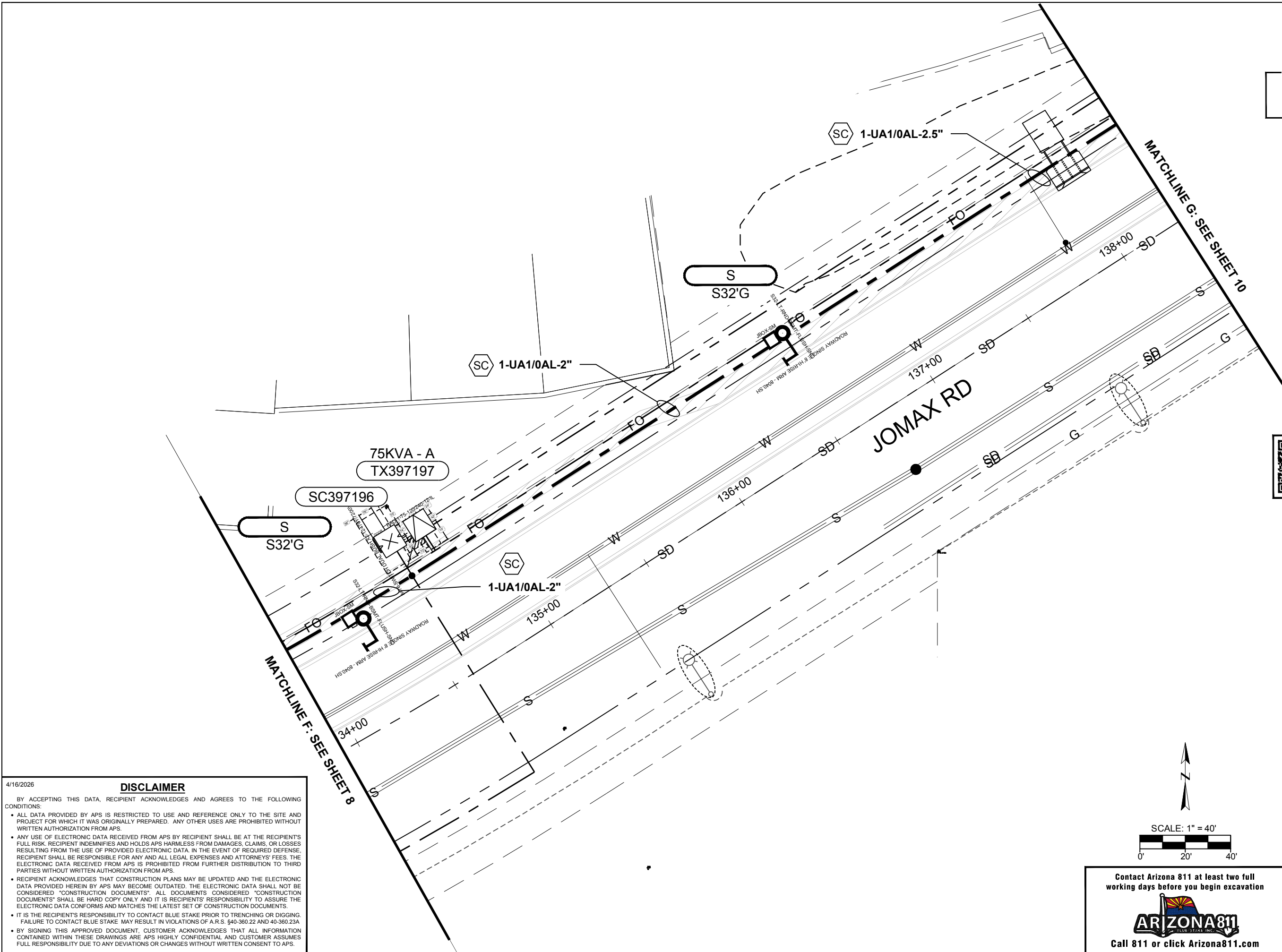

SCAN QR CODE TO VISIT  
**APS CONSTRUCTION SERVICES WEBSITE**

DATA MODIFIED PER FIELD CONDITIONS  
 VICINITY MAP

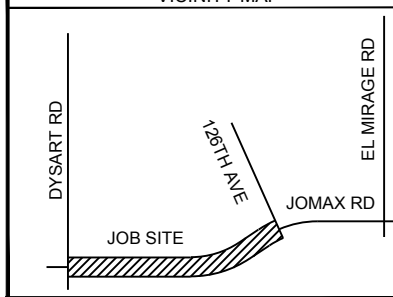

QUARTER SECTION GRID DATA

T4N	R1W	Sec 02 NE 1/4	MAP#
T5N	R1W	Sec 35 SE 1/4	MAP#
T	R	Sec 1/4	MAP#
T	R	Sec 1/4	MAP#
T	R	Sec 1/4	MAP#

CONTACT: RONNIE GANDARA  
 PHONE: MOBILE: 602-320-7069  
 INSPECTOR:  
 PHONE: MOBILE:

REVISION

DATE	DESCRIPTION	BY
------	-------------	----

4/16/2026  
**DISCLAIMER**  
 BY ACCEPTING THIS DATA, RECIPIENT ACKNOWLEDGES AND AGREES TO THE FOLLOWING CONDITIONS:  
 • ALL DATA PROVIDED BY APS IS RESTRICTED TO USE AND REFERENCE ONLY TO THE SITE AND PROJECT FOR WHICH IT WAS ORIGINALLY PREPARED. ANY OTHER USES ARE PROHIBITED WITHOUT WRITTEN AUTHORIZATION FROM APS.  
 • ANY USE OF ELECTRONIC DATA RECEIVED FROM APS BY RECIPIENT SHALL BE AT THE RECIPIENT'S FULL RISK. RECIPIENT INDEMNIFIES AND HOLDS APS HARMLESS FROM DAMAGES, CLAIMS, OR LOSSES RESULTING FROM THE USE OF PROVIDED ELECTRONIC DATA. IN THE EVENT OF REQUIRED DEFENSE, RECIPIENT SHALL BE RESPONSIBLE FOR ANY AND ALL LEGAL EXPENSES AND ATTORNEYS' FEES. THE ELECTRONIC DATA RECEIVED FROM APS IS PROHIBITED FROM FURTHER DISTRIBUTION TO THIRD PARTIES WITHOUT WRITTEN AUTHORIZATION FROM APS.  
 • RECIPIENT ACKNOWLEDGES THAT CONSTRUCTION PLANS MAY BE UPDATED AND THE ELECTRONIC DATA PROVIDED HEREIN BY APS MAY BECOME OUTDATED. THE ELECTRONIC DATA SHALL NOT BE CONSIDERED "CONSTRUCTION DOCUMENTS". ALL DOCUMENTS CONSIDERED "CONSTRUCTION DOCUMENTS" SHALL BE HARD COPY ONLY AND IT IS RECIPIENT'S RESPONSIBILITY TO ASSURE THE ELECTRONIC DATA CONFORMS AND MATCHES THE LATEST SET OF CONSTRUCTION DOCUMENTS.  
 • IT IS THE RECIPIENT'S RESPONSIBILITY TO CONTACT BLUE STAKE PRIOR TO TRENCHING OR DIGGING. FAILURE TO CONTACT BLUE STAKE MAY RESULT IN VIOLATIONS OF A.R.S. §40-360.22 AND 40-360.23A  
 • BY SIGNING THIS APPROVED DOCUMENT, CUSTOMER ACKNOWLEDGES THAT ALL INFORMATION CONTAINED WITHIN THESE DRAWINGS ARE APS HIGHLY CONFIDENTIAL AND CUSTOMER ASSUMES FULL RESPONSIBILITY DUE TO ANY DEVIATIONS OR CHANGES WITHOUT WRITTEN CONSENT TO APS.

Contact Arizona 811 at least two full working days before you begin excavation

Call 811 or click Arizona811.com

**WA997728**  
**JOMAX RD EXTENSION**  
**DYASRT RD TO 126TH DR**  
 FILE: WA997728.DWG  
 BY: ARUSI DATE: 03/30/2026  
 SCALE: 1:40 SHEET 9 OF 10

4/16/2026 11:22 AM DESIGN DRAWING SHALL BE PRINTED ON "B" OR TABLOID/LEDGER SIZE (11"X17") PAPER.

NOT APPROVED FOR CONSTRUCTION  
**PRELIMINARY**  
 03/30/2026 ARUSI

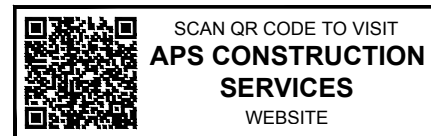
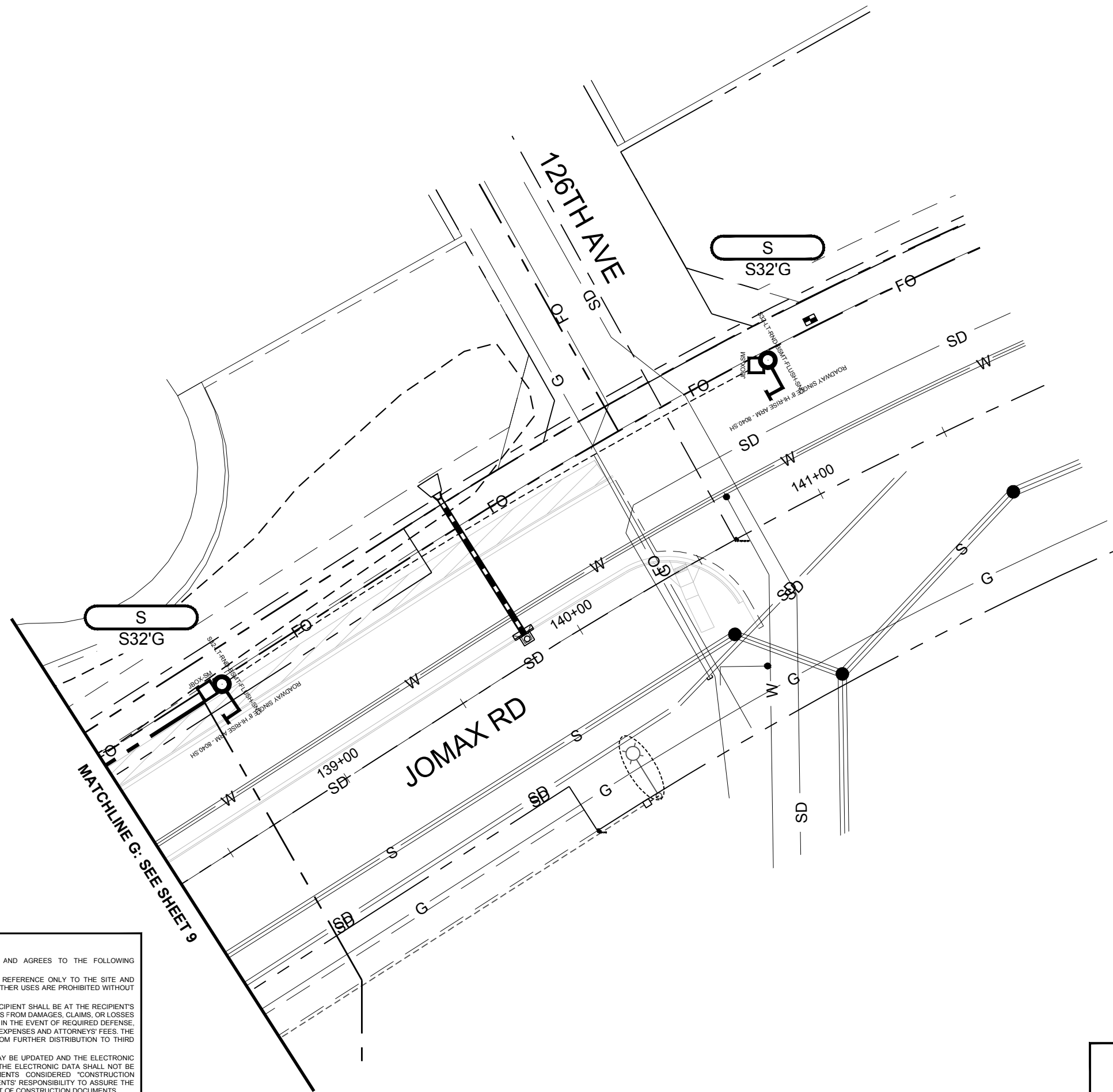

DATA MODIFIED PER FIELD CONDITIONS  
 VICINITY MAP

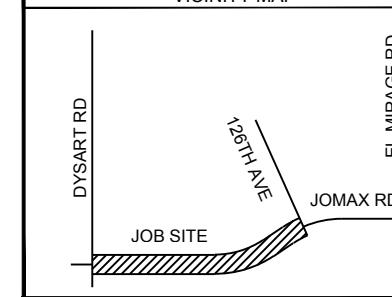

QUARTER SECTION GRID DATA

T4N	R1W	Sec 02 NE 1/4	MAP#
T5N	R1W	Sec 35 SE 1/4	MAP#
T	R	Sec 1/4	MAP#
T	R	Sec 1/4	MAP#
T	R	Sec 1/4	MAP#

CONTACT: RONNIE GANDARA  
 PHONE: MOBILE: 602-320-7069  
 INSPECTOR:  
 PHONE: MOBILE:

REVISION

DATE	DESCRIPTION	BY
------	-------------	----

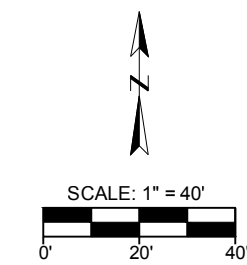

4/16/2026  
**DISCLAIMER**  
 BY ACCEPTING THIS DATA, RECIPIENT ACKNOWLEDGES AND AGREES TO THE FOLLOWING CONDITIONS:  
 • ALL DATA PROVIDED BY APS IS RESTRICTED TO USE AND REFERENCE ONLY TO THE SITE AND PROJECT FOR WHICH IT WAS ORIGINALLY PREPARED. ANY OTHER USES ARE PROHIBITED WITHOUT WRITTEN AUTHORIZATION FROM APS.  
 • ANY USE OF ELECTRONIC DATA RECEIVED FROM APS BY RECIPIENT SHALL BE AT THE RECIPIENT'S FULL RISK. RECIPIENT INDEMNIFIES AND HOLDS APS HARMLESS FROM DAMAGES, CLAIMS, OR LOSSES RESULTING FROM THE USE OF PROVIDED ELECTRONIC DATA. IN THE EVENT OF REQUIRED DEFENSE, RECIPIENT SHALL BE RESPONSIBLE FOR ANY AND ALL LEGAL EXPENSES AND ATTORNEYS' FEES. THE ELECTRONIC DATA RECEIVED FROM APS IS PROHIBITED FROM FURTHER DISTRIBUTION TO THIRD PARTIES WITHOUT WRITTEN AUTHORIZATION FROM APS.  
 • RECIPIENT ACKNOWLEDGES THAT CONSTRUCTION PLANS MAY BE UPDATED AND THE ELECTRONIC DATA PROVIDED HEREIN BY APS MAY BECOME OUTDATED. THE ELECTRONIC DATA SHALL NOT BE CONSIDERED "CONSTRUCTION DOCUMENTS". ALL DOCUMENTS CONSIDERED "CONSTRUCTION DOCUMENTS" SHALL BE HARD COPY ONLY AND IT IS RECIPIENT'S RESPONSIBILITY TO ASSURE THE ELECTRONIC DATA CONFORMS AND MATCHES THE LATEST SET OF CONSTRUCTION DOCUMENTS.  
 • IT IS THE RECIPIENT'S RESPONSIBILITY TO CONTACT BLUE STAKE PRIOR TO TRENCHING OR DIGGING. FAILURE TO CONTACT BLUE STAKE MAY RESULT IN VIOLATIONS OF A.R.S. §40-360.22 AND 40-360.23A  
 • BY SIGNING THIS APPROVED DOCUMENT, CUSTOMER ACKNOWLEDGES THAT ALL INFORMATION CONTAINED WITHIN THESE DRAWINGS ARE APS HIGHLY CONFIDENTIAL AND CUSTOMER ASSUMES FULL RESPONSIBILITY DUE TO ANY DEVIATIONS OR CHANGES WITHOUT WRITTEN CONSENT TO APS.

Contact Arizona 811 at least two full working days before you begin excavation

Call 811 or click Arizona811.com

**WA997728**  
**JOMAX RD EXTENSION**  
**DYASRT RD TO 126TH DR**  
 FILE: WA997728.DWG  
 BY: ARUSI DATE: 03/30/2026  
 SCALE: 1:40 SHEET 10 OF 10

4/16/2026 11:22 AM DESIGN DRAWING SHALL BE PRINTED ON "B" OR TABLOID/LEDGER SIZE (11"X17") PAPER.