

WA997725 12kV RELOCATE @ DYSART AND JOMAX RD.



SCOPE OF WORK:

RELOCATE POLE P462047
APPROXIMATELY 56' EAST TO
ACCOMMODATE FOR NEW ROAD
IMPROVEMENTS BY THE CITY OF PEORIA .
EXISTING OVERHEAD AND UNDERGROUND
TO BE TRANSFERRED TO NEW POLE
P919221.

CUE #:

TBD

PRIMARY 1-LINE

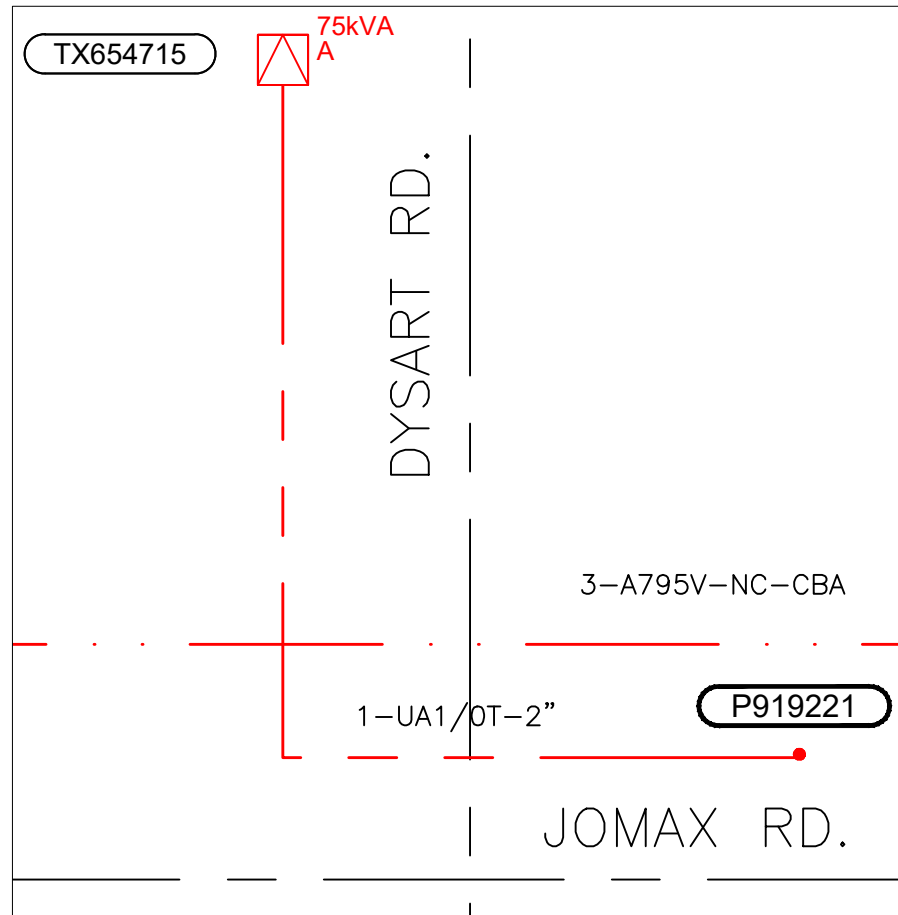

CITY OF PEORIA UTILITY CONSTRUCTION NOTES

- All work performed in the City of Peoria ROW and alleys will require an accepted traffic control plan prepared by a barricade company approved to work in the City of Peoria and shall be governed by the latest City of Phoenix Traffic Control and Barricade Manual. The Contractor/utility company shall have a copy of the approved construction plans, approved traffic control permit/plans and construction permit at the project site at all times.
- Plan approval by the City of Peoria for compliance with City requirements shall not prevent the City from requiring correction of errors found to be in violation of any law, ordinance, or City of Peoria requirements for utility construction in the ROW. The City of Peoria does not warrant any of the quantities shown on these plans.
- All utility construction shall conform to the latest Maricopa Association of Governments (MAG) Uniform Standard Specifications and Details for Public Work construction and to the City of Peoria Supplements to MAG details.
- All utility work crossing existing streets must be accomplished by horizontal directional drilling, unless otherwise approved by City. All utilities crossing streets or roads being bored/horizontal directional drilled shall comply with MAG 608 and MAG 212 where possible. All street or road crossings shall be placed within conduit(s) or sleeves.
- The Engineering Inspection Division must be notified no more than 5 business days and not less than 24 hours prior to commencement of construction. The permit number and location must be provided.
- Proper notification must be made to all effected residents. This includes notification/information signs and hanging of door notices. Door hangers shall be hung prior to blue-staking and commencing non-emergency work.
- All work requiring asphalt replacement, concrete replacement or resurfacing in the ROW will require a final inspection with the utility company representative at the time of completion. Temporary pavement replacement that uses cold-mix asphalt shall be replaced no later than 7-business days after initial placement. This also includes pavement markings.
- All potholes for existing utility crossings or soil borings for future utilities will be repaired with a full depth T-top per MAG Standard Detail 212. The City may require additional repairs, as required by the Engineering Inspector.
- The following items shall be approved in the field by the Engineering Inspector to account for unforeseen conditions;
 - Backfill and compaction;
 - Concrete repair and curing;
 - Asphalt repair and pavement matching
- When excavating in or adjacent to landscaping within the ROW, the Contractor shall contact the property owner, HOA or management company regarding the location of underground irrigation facilities.
- All trenches in existing and future pavement are required to be backfilled with a minimum of 1/2 sack slurry controlled low strength material and all trenching within 2-feet of the back of curb or edge of pavement will require ABC compacted to 95% or 1/2 sack slurry controlled low-strength material per MAG sections 604 and 728.
- Any damage to public or private property shall be reported to the City of Peoria and the property owner. Repair and/or replacement, in kind, shall be coordinated with the property owner and/or the City.
- All work that lies within a special flood hazard area (SFHA) will require a floodplain review by the Floodplain Administrator or their designee and additional stipulations may be required.
- The jobsite shall be cleaned of any debris or spoils resulting from this project at the completion of the project.
- The utility provider is responsible for obtaining a Nation Pollution Discharge Elimination System (NPDES) permit in accordance with Federal and State Regulations, including Notice of Intent (NOI), Notice of Termination (NOT), and Storm Water Pollution Prevention Plan (SWPPP), as necessary.
- The utility provider is responsible for obtaining a Dust Control Permit in accordance with Maricopa County Rule 310.
- It will be the Provider's/Contractor's responsibility to coordinate all work on private streets with the Homeowners Association (HOA).

GENERAL CONSTRUCTION NOTES
CUSTOMER TO PROVIDE & INSTALL:

- STAKING PROPERTY CORNERS WITH OFFICIAL SURVEY CAPS. ELEVATIONS AND GRADES. THERE IS A RESTAKING FEE IF RESURVEYING IS REQUIRED DUE TO APS SURVEY STAKES BEING DESTROYED IN THE FIELD.
- ALL APPROVED TRENCH & CONDUIT MATERIALS IN COMPLIANCE WITH THE A.P.S. TRENCH AGREEMENT & THE TRANSMISSION & DISTRIBUTION CONSTRUCTION STANDARDS, UNLESS OTHERWISE NOTED.

APS TO PROVIDE, CUSTOMER TO INSTALL:

- EQUIPMENT PADS (EXCEPT 3-PHASE TRANSFORMER PADS), J-BOXES, PULL BOXES, FLAT STRAP AND MANHOLES UNLESS NOTED OTHERWISE. PLEASE CONTACT CSR TO ARRANGE TO PICK UP YOUR MATERIAL.

COORDINATE WITH WO# _____

Curbs and Sidewalks
SIDEWALKS AND CURBS INSTALLED PRIOR TO THE COMPLETION OF APS CONSTRUCTION, WHICH MAY INTERFERE WITH APS CONSTRUCTION, WILL BE REPAIRED AT CUSTOMER'S EXPENSE.

Revisions
THERE WILL BE A CHARGE TO THE CUSTOMER FOR CHANGES MADE AT THE REQUEST OF THE CUSTOMER TO THE FINAL DESIGN.

Easements
TRENCH, CONDUIT, AND ANY OTHER FACILITIES INSTALLED PRIOR TO OBTAINING EASEMENTS IS AT THE RISK OF THE CUSTOMER. IF THE FINAL DESIGN MUST CHANGE BECAUSE EASEMENTS CANNOT BE GRANTED, THE CUSTOMER IS RESPONSIBLE FOR ALL COST AND INSTALLATION ASSOCIATED WITH THE CHANGE.

Permits
APS WILL SUBMIT PERMITS. CONTRACTOR MUST SHOW PROOF OF BOND AND SIGN PERMITS PRIOR TO STARTING WORK.

Existing Underground Electric Lines
THE LOCATION OF LINES IS APPROXIMATE AND THE AS-BUILT LOCATIONS IN THE FIELD MAY BE DIFFERENT.

EXISTING		PROPOSED	
W	WATER	W	WATER
S	SEWER	S	SEWER
G	GAS	G	GAS
SD	STORM DRAIN	SD	STORM DRAIN
IRR	IRRIGATION	IRR	IRRIGATION
TS	TRAFFIC SIGNAL	TS	TRAFFIC SIGNAL
T	TELCO	T	TELCO
CATV	CABLE TV	CATV	CABLE TV
FO	FIBER	FO	FIBER
	OH TRANSMISSION (69KV)*		OH TRANSMISSION (69KV)*
	OH PRIMARY (12,470/7,200V)*		OH PRIMARY (12,470/7,200V)*
	OH SECONDARY/SERVICE (120/240V)*		OH SECONDARY/SERVICE (120/240V)*
	UG TRANSMISSION (69KV)*		UG TRANSMISSION (69KV)*
	UG PRIMARY (12,470/7,200V)*		UG PRIMARY (12,470/7,200V)*
	UG SECONDARY/SERVICE (120/240V)*		UG SECONDARY/SERVICE (120/240V)*
	SPARE CONDUIT		SPARE CONDUIT
	TRENCH RUNNING LINE		TRENCH RUNNING LINE
	* UNLESS OTHERWISE NOTED		* UNLESS OTHERWISE NOTED

EXISTING		PROPOSED	
△	PADMOUNT TRANSFORMER	△	PADMOUNT TRANSFORMER
⊞	SWITCHING CABINETS	⊞	SWITCHING CABINETS
J	1Ø SWITCHING CABINET	J	1Ø SWITCHING CABINET
⊞	OH/UG CAPACITOR BANK	⊞	OH/UG CAPACITOR BANK
□	J-BOX / PULL BOX	□	J-BOX / PULL BOX
⊞	MANHOLES	⊞	MANHOLES
△	OH TRANSFORMER	△	OH TRANSFORMER
⊞	OH SWITCH (KPF)	⊞	OH SWITCH (KPF)
○	APS OWNED POLE	○	APS OWNED POLE
⊞	APS OWNED STEEL POLE	⊞	APS OWNED STEEL POLE
⊞	APS OWNED JOINT USE POLE	⊞	APS OWNED JOINT USE POLE
⊞	DIP (TRANSITION) POLE	⊞	DIP (TRANSITION) POLE
⊞	STREET LIGHT	⊞	STREET LIGHT
⊞	DUSK TO DAWN LIGHT	⊞	DUSK TO DAWN LIGHT

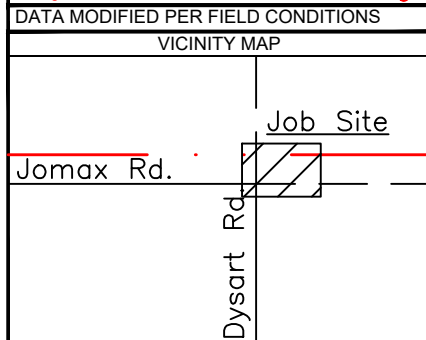
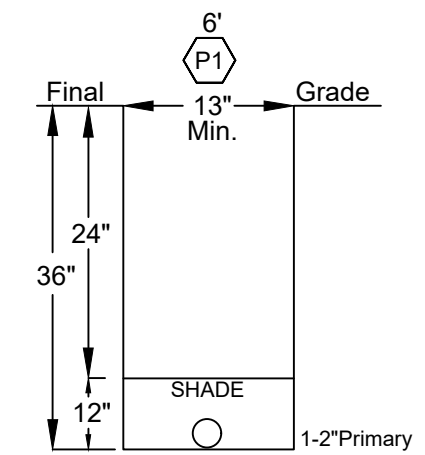

Substation: Bunker Peak
Feeder ID: BUP05
Connected kVA: Verify with local LMS

POLE DATA						
POLE	REMOVE/INSTALL	QTY	DESCRIPTION	HOLE DIA	HOLE DEPTH	BACKFILL
1907.50H1G	INSTALL	1	50 CL STEEL	30"	6.5	NATIVE
1907.50H1G	REMOVE	1	50 CL STEEL			

WIRE DATA					
WIRE	REMOVE/INSTALL	QTY	DESCRIPTION	DIA. IN.	WEIGHT PER FOOT
6215.UA1/OT	INSTALL	350'	UG PRIM	.325	.595
6215.UA1/OT	REMOVE	330'			

3/30/2026
DISCLAIMER
BY ACCEPTING THIS DATA, RECIPIENT ACKNOWLEDGES AND AGREES TO THE FOLLOWING CONDITIONS:
• ALL DATA PROVIDED BY APS IS RESTRICTED TO USE AND REFERENCE ONLY TO THE SITE AND PROJECT FOR WHICH IT WAS ORIGINALLY PREPARED. ANY OTHER USES ARE PROHIBITED WITHOUT WRITTEN AUTHORIZATION FROM APS.
• ANY USE OF ELECTRONIC DATA RECEIVED FROM APS BY RECIPIENT SHALL BE AT THE RECIPIENT'S FULL RISK. RECIPIENT INDEMNIFIES AND HOLDS APS HARMLESS FROM DAMAGES, CLAIMS, OR LOSSES RESULTING FROM THE USE OF PROVIDED ELECTRONIC DATA. IN THE EVENT OF REQUIRED DEFENSE, RECIPIENT SHALL BE RESPONSIBLE FOR ANY AND ALL LEGAL EXPENSES AND ATTORNEYS' FEES. THE ELECTRONIC DATA RECEIVED FROM APS IS PROHIBITED FROM FURTHER DISTRIBUTION TO THIRD PARTIES WITHOUT WRITTEN AUTHORIZATION FROM APS.
• RECIPIENT ACKNOWLEDGES THAT CONSTRUCTION PLANS MAY BE UPDATED AND THE ELECTRONIC DATA PROVIDED HEREIN BY APS MAY BECOME OUTDATED. THE ELECTRONIC DATA SHALL NOT BE CONSIDERED "CONSTRUCTION DOCUMENTS". ALL DOCUMENTS CONSIDERED "CONSTRUCTION DOCUMENTS" SHALL BE HARD COPY ONLY AND IT IS RECIPIENT'S RESPONSIBILITY TO ASSURE THE ELECTRONIC DATA CONFORMS AND MATCHES THE LATEST SET OF CONSTRUCTION DOCUMENTS.
• IT IS THE RECIPIENT'S RESPONSIBILITY TO CONTACT BLUE STAKE PRIOR TO TRENCHING OR DIGGING. FAILURE TO CONTACT BLUE STAKE MAY RESULT IN VIOLATIONS OF A.R.S. §40-360.22 AND 40-360.23A.
• BY SIGNING THIS APPROVED DOCUMENT, CUSTOMER ACKNOWLEDGES THAT ALL INFORMATION CONTAINED WITHIN THESE DRAWINGS ARE APS HIGHLY CONFIDENTIAL AND CUSTOMER ASSUMES FULL RESPONSIBILITY DUE TO ANY DEVIATIONS OR CHANGES WITHOUT WRITTEN CONSENT TO APS.

PERMITTING ONLY
FINAL DESIGN
03/30/2026 ARUSI

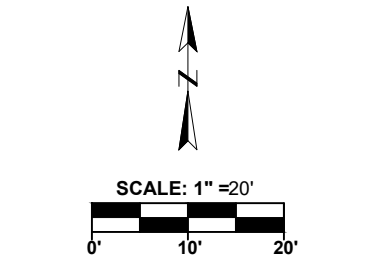

Contact Arizona 811 at least two full working days before you begin excavation
ARIZONA 811
Call 811 or click Arizona811.com

QUARTER SECTION GRID DATA			
T05N	R01W	Sec 35 SE 1/4	MAP#
T	R	Sec 1/4	MAP#
T	R	Sec 1/4	MAP#
T	R	Sec 1/4	MAP#
T	R	Sec 1/4	MAP#

CONTACT: RON GANDARA
PHONE: 602-320-7069 MOBILE:
INSPECTOR:
PHONE: MOBILE:
REVISION
DATE DESCRIPTION BY
WA997725
WA997725 12KV
RELOCATE JOMAX & DYSART RD.
FILE:WA997725 Rev2.DWG
BY: ARUSI DATE: 03/30/2026
SCALE: 1:20 SHEET 1 OF 3

3/30/2026 11:32 AM DESIGN DRAWING SHALL BE PRINTED ON "B" OR TABLOID/LEADER SIZE (11"X17") PAPER.

MARICOPA COUNTY DEPARTMENT OF
TRANSPORTATION (MCDOT) GENERAL NOTES FOR
RIGHT-OF-WAY PERMITS



- All work shall conform to the revised edition of the Uniform Standard Specifications and Details for Public Works Construction published by the Maricopa Association of Governments (MAG) as authorized and modified by the most current MCDOT supplement to the MAG Uniform Standard Specifications and Details and non-conflicting project Special Provisions. All work must also comply with Ordinance P-36 "Maricopa County Ordinance Addressing Requirements for Permits to Work in Right-of-Way within Unincorporated Maricopa County." Any exceptions must receive explicit approval from MCDOT and shall be identified on the plans as having explicit approval from MCDOT.
- Construction quantities on these plans are not verified by MCDOT. Approval of these plans is for permit purposes only and shall not prevent MCDOT from requiring correction of errors in the plans where such errors are subsequently found to be in violation of any law, ordinance, health, safety, the MCDOT Roadway Design Manual, or other applicable design standards.
- The most current approved set of plans shall be on the site during construction and available to MCDOT inspectors.
- All box culverts constructed in the public Right-Of-Way shall comply with Arizona Department of Transportation (ADOT) latest design specifications and standards.
- Contractor to obtain MCDOT permits prior to construction within County Right-Of-Way, and all necessary permits from other agencies and from local governments for work within their jurisdiction.
- Contractor shall notify the assigned MCDOT Inspector listed on permit at least 24 hours in advance of any construction
- Contractor performing construction or excavating operations is responsible for locating and relocating all utilities in conflict at no expense to Maricopa County. The Contractor shall contact Arizona 811 prior to beginning construction
- It is the responsibility of the contractor to obtain all required permits for earth moving from Maricopa County Air Quality Department's Dust Compliance Division prior to conducting excavation operations. A copy of the permit and dust control plan shall be submitted to the County Engineer prior to commencement of any earthmoving activities.
- Prior to conducting excavation operations, the Contractor shall obtain from the Arizona State Historical Preservation Officer recommendations regarding the need for cultural resources (archaeological) clearance. All discoveries of human remains, cultural artifacts, or paleontological remains shall be reported to the Arizona State Museum and MCDOT. Upon discovery, Contractor shall cease operations in the vicinity of the find and protect the discovery area from further disturbance until the find can be professionally investigated by the Arizona State Museum and MCDOT.
- Except under emergency conditions, roads shall not be closed for construction activity unless prior approval is obtained from the MCDOT Transportation Director.
- Prior to moving or destroying protected native plant species, the Contractor shall file a formal Notice of Intent with the Arizona Department of Agriculture Native Plants.
- Prior to installation of curb, gutter, sidewalk, base course and wearing surface, a pavement verification report submittal is required to be submitted to MCDOT for review and approval. If subgrade stabilization is required, the area stabilized shall be from back of sidewalk to back of sidewalk and match the stabilization depth of the pavement structure.
- Asphalt mix designs shall be submitted to MCDOT a minimum of two business days prior to placing any asphalt courses. (Trench work excluded.) Asphalt mix designs must be approved prior to paving activities. All paved turnouts shall have the same asphalt and base requirements as the adjacent roadway unless noted otherwise.
- All asphalt concrete pavement of local and minor collector roads with a longitudinal grade less than 5% shall receive a preservative seal ("filled" asphalt sealer) in accordance with Sections 334 and 718.3 of the MAG Uniform Standard Specifications.

- Except for ARAC mixes, all other AC mixes shall be Superpave/Gyratory type unless approved by MCDOT. AC mix design used on local and minor collector streets shall be for low traffic condition. Nominal size to thickness ratio shall not exceed 1:3. The nominal size designation for the surface course on urban roadways shall be a 1/2" mix, unless approved by MCDOT.
- All compaction and backfill within County Right-Of-Way shall conform to the MCDOT Supplement to MAG Specification section 601. Backfill under existing pavement, curb and gutter, roadway shoulders, and unpaved roadways shall consist of one-half (1/2) or one sack CLSM. Unpaved roadway areas include the travelled way plus five feet beyond the travelled way.
- All structures, such as manholes, valve box & covers, and monitoring wells must be marked with at least two reflective flexible posts when structures are located outside the traveled way and within the Right-Of-Way. (Applies only when there is no curb.) All clear zone hazards shall be mitigated in a manner approved by MCDOT at no cost to the County.
- Pavement widening and pavement replacement shall conform to the requirements of MAG Specification Section 336 and the MCDOT Supplement thereto. Pavement cuts shall not be located within a lane wheel path. The lane wheel path is the entire lane width except the area within one foot of a lane line stripe and except the center two feet of the travel lane.
- All existing pavement markings, traffic signs and signal equipment to be removed, replaced, relocated or repaired due to contractor's work will be done by the contractor at their expense. All salvaged signs shall be delivered to the Traffic Operations building at 2909 W. Durango St. Arrangements can be made for delivery by calling (602) 506-8662. All new street name signs shall be provided and installed by the permittee at no expense to Maricopa County.
- All permitted construction is subject to inspection and is required to meet all applicable standards prior to the release of the corresponding bond.
- The contractor shall restore all disturbed areas within the Right-Of-Way to a condition equal to or better than existing conditions per MAG 107.9. Disposal of all waste material will be the responsibility of the Contractor.
- Chipped, cracked, or imprinted curb, gutter, or sidewalk is not permitted. Concrete patching of curb, gutter, and sidewalk is not permitted.
- The permittee's Engineer of Record is required to certify subdivision construction in accordance with the MCDOT Subdivision Inspection Guidelines

3/30/2026 **DISCLAIMER**

BY ACCEPTING THIS DATA, RECIPIENT ACKNOWLEDGES AND AGREES TO THE FOLLOWING CONDITIONS:

- ALL DATA PROVIDED BY APS IS RESTRICTED TO USE AND REFERENCE ONLY TO THE SITE AND PROJECT FOR WHICH IT WAS ORIGINALLY PREPARED. ANY OTHER USES ARE PROHIBITED WITHOUT WRITTEN AUTHORIZATION FROM APS.
- ANY USE OF ELECTRONIC DATA RECEIVED FROM APS BY RECIPIENT SHALL BE AT THE RECIPIENT'S FULL RISK. RECIPIENT INDEMNIFIES AND HOLDS APS HARMLESS FROM DAMAGES, CLAIMS, OR LOSSES RESULTING FROM THE USE OF PROVIDED ELECTRONIC DATA. IN THE EVENT OF REQUIRED DEFENSE, RECIPIENT SHALL BE RESPONSIBLE FOR ANY AND ALL LEGAL EXPENSES AND ATTORNEYS' FEES. THE ELECTRONIC DATA RECEIVED FROM APS IS PROHIBITED FROM FURTHER DISTRIBUTION TO THIRD PARTIES WITHOUT WRITTEN AUTHORIZATION FROM APS.
- RECIPIENT ACKNOWLEDGES THAT CONSTRUCTION PLANS MAY BE UPDATED AND THE ELECTRONIC DATA PROVIDED HEREIN BY APS MAY BECOME OUTDATED. THE ELECTRONIC DATA SHALL NOT BE CONSIDERED "CONSTRUCTION DOCUMENTS". ALL DOCUMENTS CONSIDERED "CONSTRUCTION DOCUMENTS" SHALL BE HARD COPY ONLY AND IT IS RECIPIENT'S RESPONSIBILITY TO ASSURE THE ELECTRONIC DATA CONFORMS AND MATCHES THE LATEST SET OF CONSTRUCTION DOCUMENTS.
- IT IS THE RECIPIENT'S RESPONSIBILITY TO CONTACT BLUE STAKE PRIOR TO TRENCHING OR DIGGING. FAILURE TO CONTACT BLUE STAKE MAY RESULT IN VIOLATIONS OF A.R.S. §40-360.22 AND 40-360.23A.
- BY SIGNING THIS APPROVED DOCUMENT, CUSTOMER ACKNOWLEDGES THAT ALL INFORMATION CONTAINED WITHIN THESE DRAWINGS ARE APS HIGHLY CONFIDENTIAL AND CUSTOMER ASSUMES FULL RESPONSIBILITY DUE TO ANY DEVIATIONS OR CHANGES WITHOUT WRITTEN CONSENT TO APS.

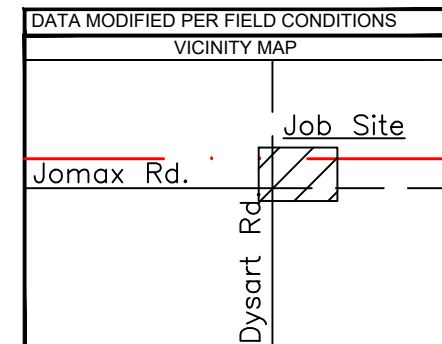
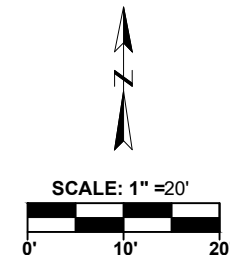

QUARTER SECTION GRID DATA				
T05N	R01W	Sec 35 SE 1/4	MAP#	
T	R	Sec	1/4	MAP#
T	R	Sec	1/4	MAP#
T	R	Sec	1/4	MAP#
T	R	Sec	1/4	MAP#

CONTACT: RON GANDARA
PHONE: 602-320-7069 MOBILE:
INSPECTOR:
PHONE: MOBILE:

REVISION		
DATE	DESCRIPTION	BY

PERMITTING ONLY
FINAL DESIGN
03/30/2026 ARUSI

Contact Arizona 811 at least two full working days before you begin excavation

Call 811 or click Arizona811.com

WA997725
WA997725 12KV
RELOCATE JOMAX & DYSART RD.

FILE: WA997725 Rev2.DWG
BY: ARUSI DATE: 03/30/2026
SCALE: 1:20 SHEET 2 OF 3

3/30/2026 11:33 AM DESIGN DRAWING SHALL BE PRINTED ON "B" OR TABLOID/LEDGER SIZE (11"X17") PAPER.

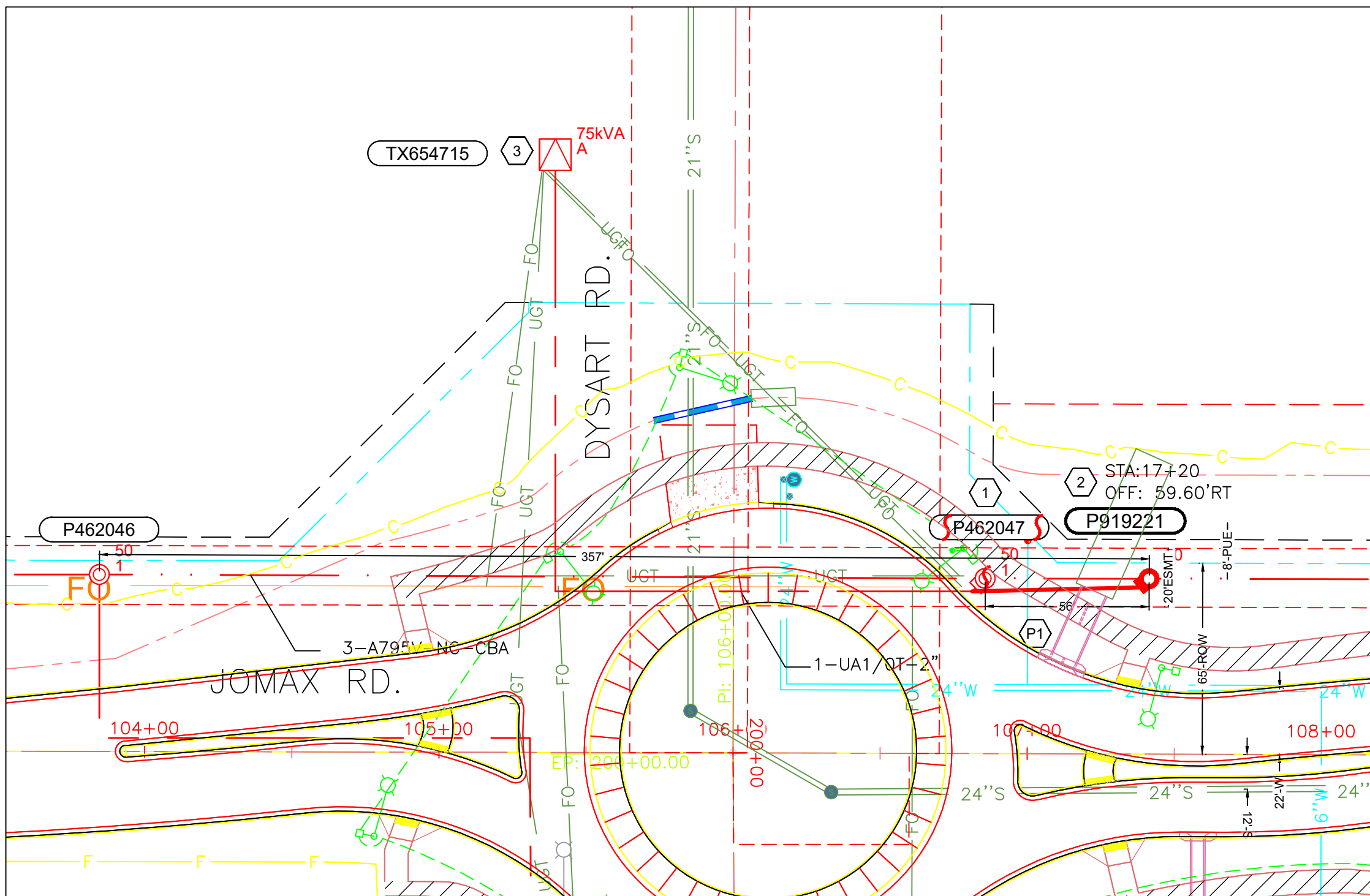

REMOVE

- ① 1907.501
- 3131.SC3
- 5106.

INSTALL

- ② 1907.501G
- 3130.SC3N1
- 5106.S2KG112
- 8881.DQ

REMOVE INSTALL

- ③ 2894.FA112 / 2894.FA112

INSTALL

- P1 8876.FA (60')
- 8890.FD
- 8895.MR (TOTAL POLR-XFMR)
- 8895.ML (3)
- 8880.CL
- 8895.PQ
- 8895.YQ

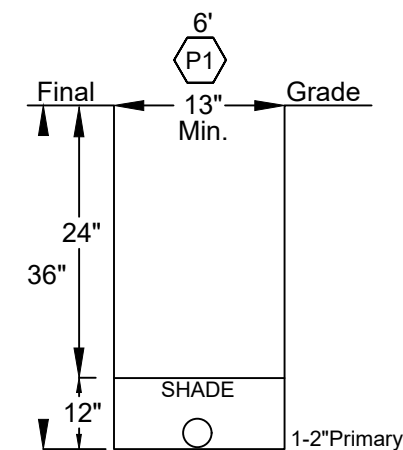

DATA MODIFIED PER FIELD CONDITIONS

VICINITY MAP

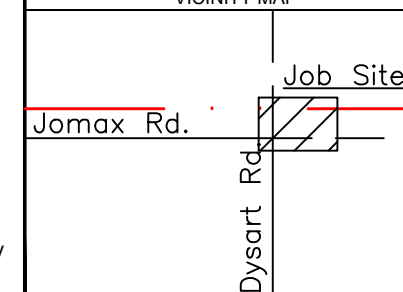

QUARTER SECTION GRID DATA

T05N	R01W	Sec 35 SE 1/4	MAP#
T	R	Sec	1/4 MAP#
T	R	Sec	1/4 MAP#
T	R	Sec	1/4 MAP#
T	R	Sec	1/4 MAP#

CONTACT: RON GANDARA

PHONE: 602-320-7069 MOBILE:

INSPECTOR:

PHONE: MOBILE:

REVISION

DATE DESCRIPTION BY

WA997725

WA997725 12KV

RELOCATE JOMAX & DYSART RD.

FILE:WA997725 Rev2.DWG

BY: ARUSI DATE: 03/30/2026

SCALE: 1:20 SHEET 3 OF 3

3/30/2026 **DISCLAIMER**

BY ACCEPTING THIS DATA, RECIPIENT ACKNOWLEDGES AND AGREES TO THE FOLLOWING CONDITIONS:

- ALL DATA PROVIDED BY APS IS RESTRICTED TO USE AND REFERENCE ONLY TO THE SITE AND PROJECT FOR WHICH IT WAS ORIGINALLY PREPARED. ANY OTHER USES ARE PROHIBITED WITHOUT WRITTEN AUTHORIZATION FROM APS.
- ANY USE OF ELECTRONIC DATA RECEIVED FROM APS BY RECIPIENT SHALL BE AT THE RECIPIENT'S FULL RISK. RECIPIENT INDEMNIFIES AND HOLDS APS HARMLESS FROM DAMAGES, CLAIMS, OR LOSSES RESULTING FROM THE USE OF PROVIDED ELECTRONIC DATA. IN THE EVENT OF REQUIRED DEFENSE, RECIPIENT SHALL BE RESPONSIBLE FOR ANY AND ALL LEGAL EXPENSES AND ATTORNEYS' FEES. THE ELECTRONIC DATA RECEIVED FROM APS IS PROHIBITED FROM FURTHER DISTRIBUTION TO THIRD PARTIES WITHOUT WRITTEN AUTHORIZATION FROM APS.
- RECIPIENT ACKNOWLEDGES THAT CONSTRUCTION PLANS MAY BE UPDATED AND THE ELECTRONIC DATA PROVIDED HEREIN BY APS MAY BECOME OUTDATED. THE ELECTRONIC DATA SHALL NOT BE CONSIDERED "CONSTRUCTION DOCUMENTS". ALL DOCUMENTS CONSIDERED "CONSTRUCTION DOCUMENTS" SHALL BE HARD COPY ONLY AND IT IS RECIPIENT'S RESPONSIBILITY TO ASSURE THE ELECTRONIC DATA CONFORMS AND MATCHES THE LATEST SET OF CONSTRUCTION DOCUMENTS.
- IT IS THE RECIPIENT'S RESPONSIBILITY TO CONTACT BLUE STAKE PRIOR TO TRENCHING OR DIGGING. FAILURE TO CONTACT BLUE STAKE MAY RESULT IN VIOLATIONS OF A.R.S. §40-360.22 AND 40-360.23A.
- BY SIGNING THIS APPROVED DOCUMENT, CUSTOMER ACKNOWLEDGES THAT ALL INFORMATION CONTAINED WITHIN THESE DRAWINGS ARE APS HIGHLY CONFIDENTIAL AND CUSTOMER ASSUMES FULL RESPONSIBILITY DUE TO ANY DEVIATIONS OR CHANGES WITHOUT WRITTEN CONSENT TO APS.

ISSUED FOR CONSTRUCTION
FINAL DESIGN
 03/30/2026 ARUSI

Contact Arizona 811 at least two full working days before you begin excavation

Call 811 or click Arizona811.com

3/10/2026 DESIGN DRAWING SHALL BE PRINTED ON "B" OR TABLOID/LEDGER SIZE (11"x17") PAPER.